

# PROCEDURE FOR REPLACING ROTARY BROOM BRUSHES

## 47" AND 60" ROTARY BROOMS WITH 18" DIAMETER BRUSHES

(Figures 1-1a)

**Important:** Replace the brushes when the diameter reaches 10".

1. Place the tractor/equipment on level ground, place transmission in neutral, wait for all movement to stop and apply parking brake.
2. Raise the broom to its maximum and turn it completely to the left. Securely support with stands or suitable blocking. Do not rely on hydraulically supported devices for your safety. They can settle suddenly, leak down, or be accidentally lowered. Shut off the engine and remove the ignition key.
3. Remove the two bolts (item 2) and withdraw the chain guard (item 1).
4. Remove the right side of the broom (item 5) by unscrewing the three nuts (item 4), the nine bolts (item 3), the lockwasher and the nut (item 6).
5. Remove the bearing and the flanges (item 13) by unscrewing the two setscrews from the bearing.
6. Remove the retaining plate (item 7) by unscrewing the three bolts (item 8).
7. Remove the brushes by sliding them towards the outside of the brush support (item 11).

8. Begin installing the wafers on the brush support, ensuring the drive pins of each wafer section lock the wafer over one of the brush support's drive bar.
9. Install each brush (item 9) in the opposite direction of the one next to it (see **Figure 1a**). The two pins on each brush (item 10) that secure the brushes to the support must be alternated 120° (1/3 of a turn) to obtain a balanced distribution on each of the support's three square tubes (item 11).

**IMPORTANT:** If you decide to install half steel/half polypropylene brushes, you must start and finish with a polypropylene brush.

10. Install the retaining plate (item 7) by tightening the bolts (item 8) and lockwashers firmly.
11. Install the bearing and the flanges (item 13) on the right side (item 5) and reinstall the right side of the broom. Tighten the bearing setscrews (item 13).
12. Check the condition of the chain and realign the chain tensioner (item 12).
13. Reinstall the chain guard (item 1).

**IMPORTANT:** While installing the new brush, take care to tighten the bearing setscrews and to align the chain tensioner.

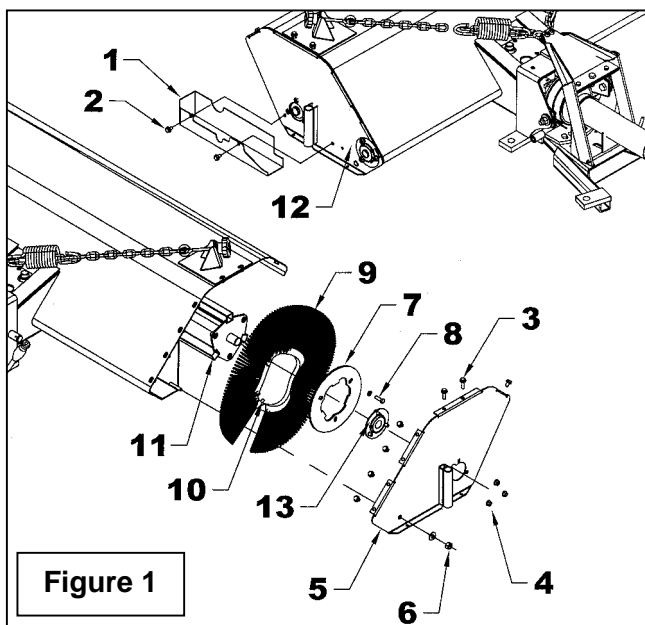

Figure 1

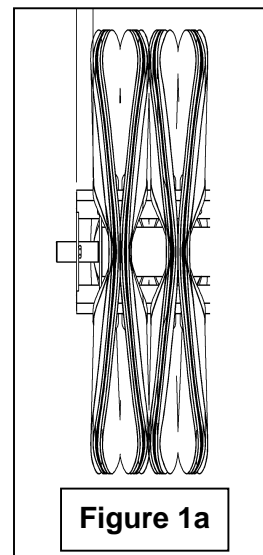

Figure 1a

---

## PROCEDURE FOR REPLACING ROTARY BROOM BRUSHES

---

### 60" AND 72" ROTARY BROOMS WITH 22" DIAMETER BRUSHES

**Important:** Replace the brushes when the diameter reaches 15".

1. Place the tractor mounted with the broom on a clean, flat and level surface. Put the transmission in neutral, apply the parking brake, raise the broom with the lifting mechanism, turn off the engine and wait for the brush to stop turning completely.
2. **Figure 2:** Remove the chain idler (item 1) from the broom housing (item 2) by removing the 3/8"NC nylon insert locknut (item 3), the 3/8" lockwasher (item 4) and the 3/8" flat washer (item 5).
3. **Figure 2a:** Place the two engagement levers (item 4) in the "A" position and, using the tractor's hydraulic lever, lower the broom so the brush touches the ground.
4. **Figure 2a:** Remove the 1/2"NC x 1 1/4"lg hex. bolts (item 1) , the flat washers 3/8" (item 6) and the 1/2"NC serrated flange nuts (item 2) from the brush support right side bearing (item 3).
5. **Figure 2a:** Place the engagement levers (item 4) to position "B" to release the brushes from the broom housing (item 5). If the brushes aren't released sufficiently from the broom, raise the broom as needed with the subframe lift mechanism.
6. **Figure 2b:** Remove the three 5/16"NC x 1" lg. hex bolts (item 2), the three 5/16" lockwashers (item 3) and the retaining plate (item 1) from the brush support (item 5). Take off all the brushes (item 4) from the brush support (item 5).
7. **Figure 2b:** Install each brush (item 4) in the opposite direction of the one next to it (see **Figure 2c**). The two pins on each brush (item 4a) that secure the brushes to the support must be alternated 120° (1/3 of a turn) to obtain a balanced distribution on each of the support's three square tubes (item 5a).
8. **Figure 2b:** Secure the brushes with the retaining plate (item 1), the three. 5/16"NC x 1" lg. hex bolts (item 2) and the three 5/16" lockwashers (item 3).
9. **Figure 2a:** Lower the broom housing (item 5) by moving the engagement levers (item 4) in the "A." position. If the housing is too high to align the holes of bearing (item 3) with those of the housing (item 5) , lower the housing as needed with the subframe lift mechanism.
10. **Figure 2a:** Attach the brush support bearing (item 3) with the two 1/2"NC x 1 1/4"lg hex bolts (item 1), the 3/8" flat washers (item 6) and 1/2"NC serrated flange nuts (item 2).
11. **Figure 2:** Reinstall the chain idler (item 1) with the 3/8"NC nylon insert locknut (item 3), 3/8" lockwasher (item 4) and the 3/8" flat washer (item 5). Refer to figure 14 instructions for the proper chain adjustment.

**IMPORTANT:** If you decide to install half steel/half polypropylene brushes, you must start and finish with a polypropylene brush.

# PROCEDURE FOR REPLACING ROTARY BROOM BRUSHES

