

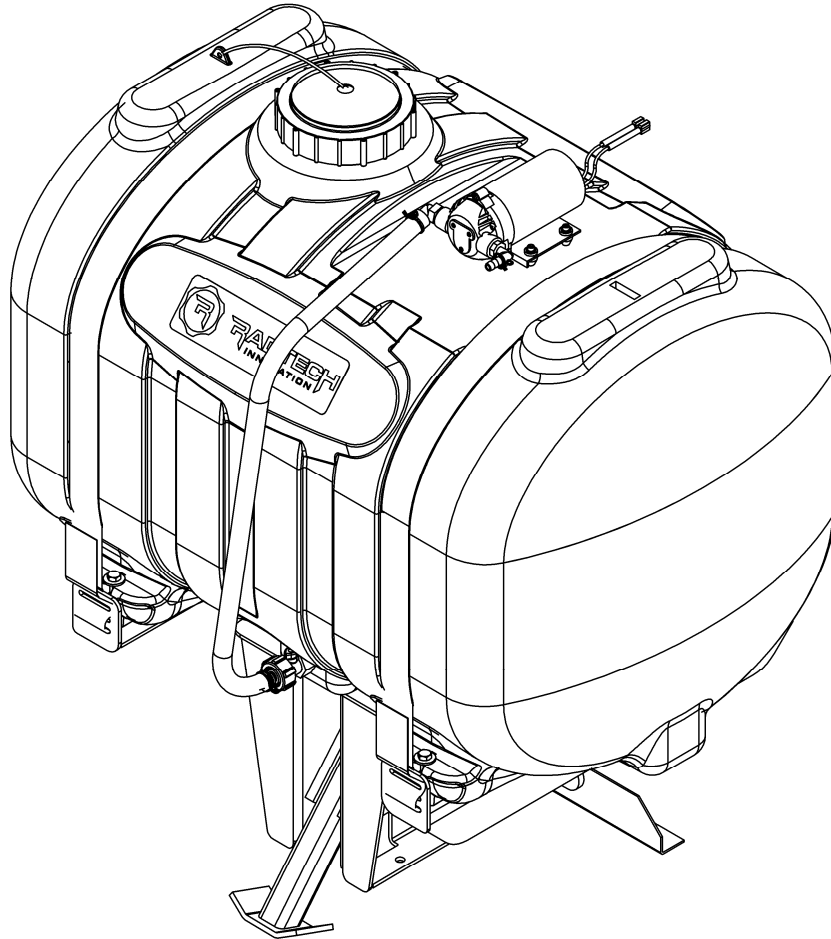

RADTECH
INNOVATION



OPERATOR'S AND PARTS MANUAL

BER0061 - SPRAYING KIT

OM 0372SPR-A
06/13



TABLE OF CONTENT

ASSEMBLY.....	2
Assembly of the Dust Suppression Kit.....	2
Installation of Nozzle Supports on Rotary Broom.....	2
Assembly of Nozzle Supports.....	2
Installation with a Dust Deflector only.....	3
Installation with a Dust Deflector and a Lawn Dethatching Wheel Kit.....	4
Installation of the Rotary Broom.....	5
Installation of Electric Components.....	7
OPERATION.....	8
Preparation.....	8
Filling of the Tank and Preparation.....	8
Operation.....	9
MAINTENANCE.....	9
Cleaning and Replacement of the nozzles and filters.....	9
Nozzle alignment.....	9
Nozzle Wearing out Table.....	9
Strap Tension after Tank Filling.....	10
Cleaning and Replacement of the Pump Suction Filter.....	10
Storage.....	10
TROUBLESHOOTING.....	11
PERIODIC CHECKS.....	11
PARTS.....	12
Introduction.....	12
Tank Components.....	13
Tank and Support.....	14
Nozzles Supports.....	16
Electric Components.....	17
TORQUE SPECIFICATION TABLE.....	18

ASSEMBLY

ASSEMBLY OF THE DUST SUPPRESSION KIT

The Dust Suppression Kit is pre-assembled at the factory; however, some parts must be installed. Use the present manual and lay out all parts for assembly. Separate bolts and nuts into various sizes. After assembly, torque all the bolts according to the "Torque Specification Table" enclosed at the end of the manual.

Installation of Nozzle Supports on Rotary Broom (Figures 1 to 3)

1- Assembly of Nozzle Supports

• FOR 72" & 84" ROTARY BROOM (Fig.1a)

You must install three nozzle supports (item 1) with a "T" nozzle (item 2) and one nozzle support with a 90° elbow nozzle (item 7).

The large nozzle support is not required.

1. Remove the nuts (item 3) from the three "T" (item 2) and the 90° elbow nozzle (item 7). Insert the threaded part of each nozzle through a nozzle support (item 1). Reinstall the nuts previously removed. The "T" and the 90° elbow nozzle must be parallel to the nozzle support.
2. Insert each nozzle (item 5) in the swivel nuts (item 6). Insert the four anti-drop filters (item 4) in each three "T" and 90° elbow nozzle (items 2-7) and screw the swivel nuts (item 6). Reposition the nozzles as to align them parallel to the "T" and 90° elbow nozzle barb section. This is necessary to have a straight jet and parallel to the rotary broom.

• FOR 60" ROTARY BROOM (Fig.1b)

You must install two nozzle supports (item 1); one with a "T" nozzle (item 2) and the other with a 90° elbow nozzle. You also need a large nozzle support (item 8) with a "T" nozzle (item 2).

Two nozzle supports (item 1) and one "T" nozzle (item 2) are not required.

1. Remove the nuts (item 3) from the two "T" (item 2) and the 90° elbow nozzle (item 7). Insert the threaded part of 90° elbow nozzle (item 7) in a nozzle support (item 1) and the two "T" nozzles in a nozzle support (item 1) and the large nozzle support (item 8). Reinstall the nuts previously removed. The "T" and the 90° elbow nozzle must be parallel to the nozzle support.
2. Insert each nozzle (item 5) in the swivel nuts (item 6). Insert the three anti-drop filters (item 4) in the two "T" and the 90° elbow nozzle and screw the swivel nuts (item 6). Replace the nozzles as to align them parallel to the "T" and 90° elbow nozzle barb section. This is necessary to have a straight jet and parallel to the rotary broom.

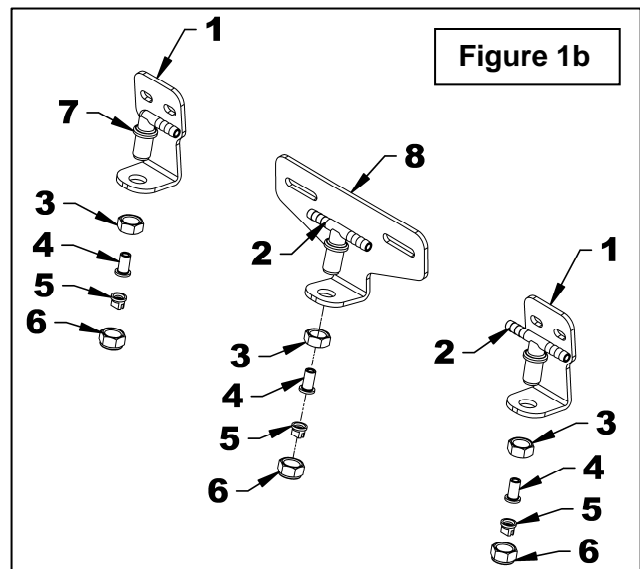
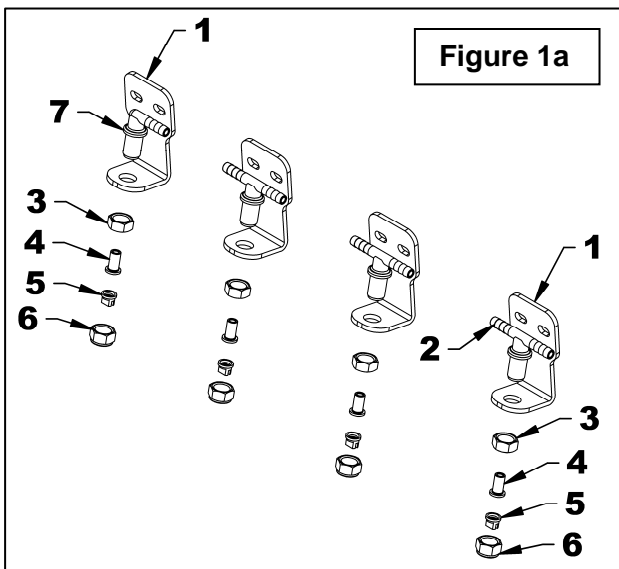

ASSEMBLY

2- Installation with a Dust Deflector only

IMPORTANT: The nozzle supports must be installed over the Dust Deflector.

• FOR 72" & 84" ROTARY BROOM (Fig.2a)

1. Beginning by the left, secure the three nozzle supports with a "T" nozzle (item 2) with two 5/16" x 1 1/4" hex bolts (item 4), two lockwashers (item 5), four flat washers (item 6) and two nylon insert lock nuts (item 7).
2. Then, secure the nozzle support with a 90° elbow nozzle (item 3) with two 5/16" x 1 1/4" hex bolts (item 4), two lockwashers (item 5), four flat washers (item 6) and two nylon insert lock nuts (item 7).

• FOR 60" ROTARY BROOM (Fig.2b)

1. Beginning by the left, secure the nozzle support with a "T" nozzle (item 2) with two 5/16" x 1 1/4" hex bolts (item 4), two lockwashers (item 5), four flat washers (item 6) and two nylon insert lock nuts (item 7).
2. Then, secure the large nozzle support (item 8) with a "T" nozzle with two 5/16" x 1 1/4" hex bolts (item 4), two lockwashers (item 5), four flat washers (item 6) and two nylon insert lock nuts (item 7).
3. Then, secure the nozzle support with a 90° elbow nozzle (item 3) with two 5/16" x 1 1/4" hex bolts (item 4), two lockwashers (item 5), four flat washers (item 6) and two nylon insert lock nuts (item 7).

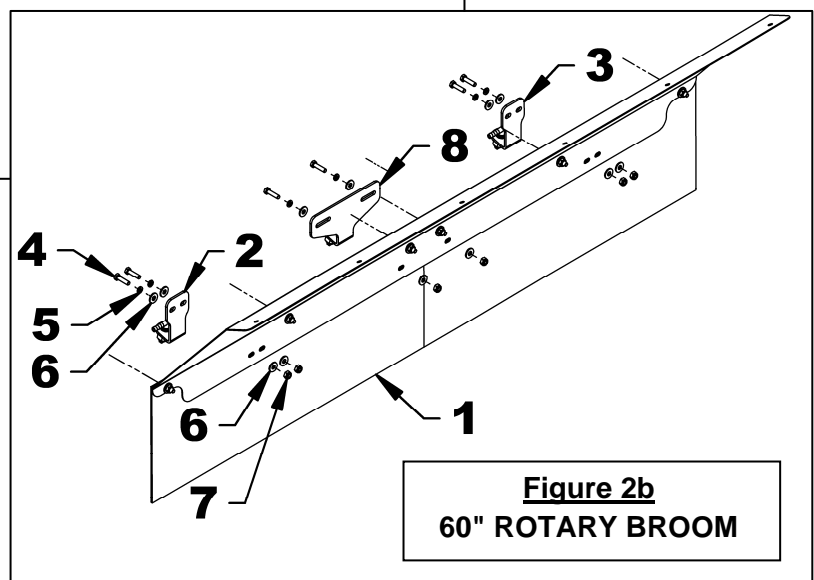
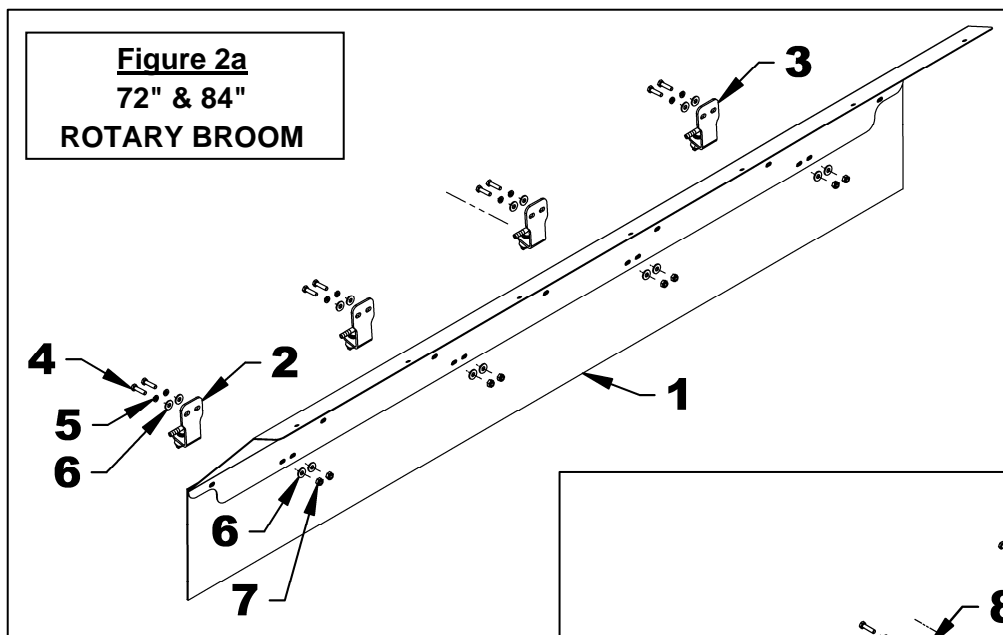

ASSEMBLY

3- Installation with a Dust Deflector and a Lawn Dethatching Wheel Kit

IMPORTANT: The nozzle supports (items 2, 3 & 8) must be installed between the dust deflector (item 1) and the Lawn Dethatching Wheel Kit (item 7).

- **FOR 72" & 84" ROTARY BROOM (Fig.3a)**

The nuts are riveted at factory in the tubes of the lawn dethatching wheel support.

1. Beginning by the left, secure the three nozzle supports with a "T" nozzle (item 2) with two 5/16" x 1 1/4" hex bolts (item 4), two lockwashers (item 5) and two flat washers (item 6).
2. Then, secure the nozzle support with a 90° elbow nozzle (item 3) with two 5/16" x 1 1/4" hex bolts (item 4), two lockwashers (item 5) and two flat washers (item 6).

- **FOR 60" ROTARY BROOM (Fig.3b)**

The nuts are riveted at factory in the tubes of the lawn dethatching wheel support.

1. Beginning by the left, secure the nozzle support with a (item 2) with two 5/16" x 1 1/4" hex bolts (item 4), two lockwashers (item 5) and two flat washers (item 6).
2. Then, secure the large nozzle support with a "T" nozzle (item 8) with two 5/16" x 1 1/4" hex bolts (item 4), two lockwashers (item 5) and two flat washers (item 6).
3. Secure the nozzle support with a 90° elbow nozzle (item 3) with two 5/16" x 1 1/4" hex bolts (item 4), two lockwashers (item 5) and two flat washers (item 6).

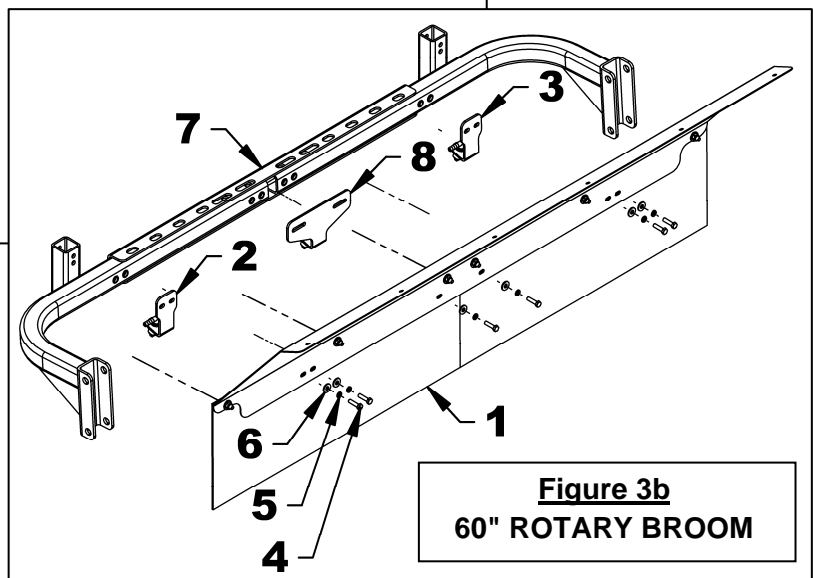
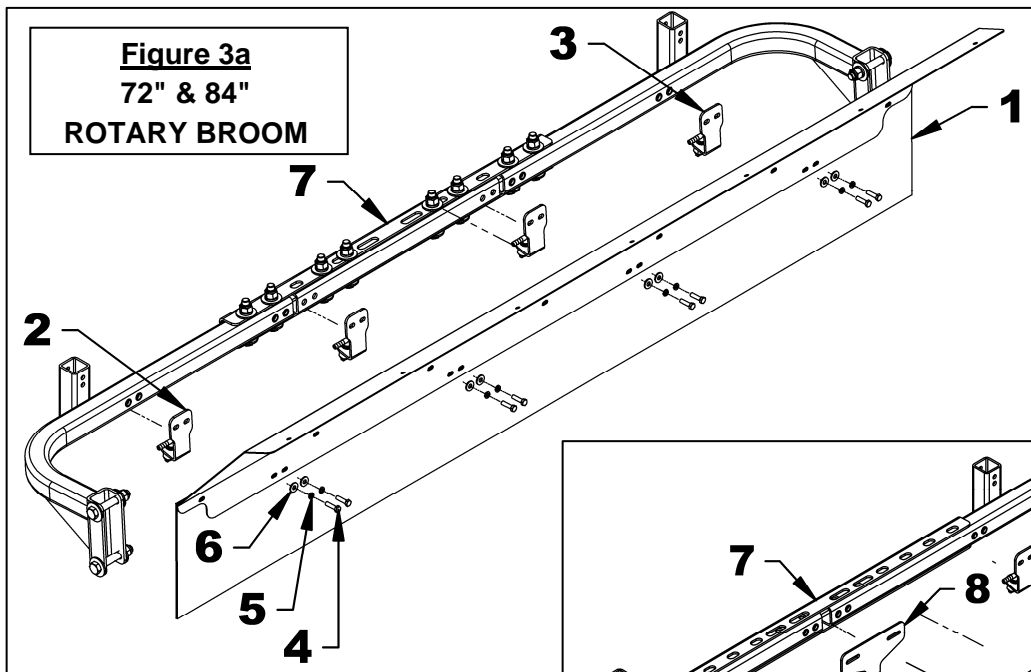

ASSEMBLY

Installation of the Rotary Broom (Figures 4 to 8)

- 1. Figure 4:** Insert the tank support (item 1) avec the flat iron welded on top of the rotary broom hitch (item 2) and secure with two 1/2" x 2"NC bolts (item 3), two 1/2" flat washers (item 4), two 1/2" lockwashers (item 5) and two 1/2" nylon insert locknuts (item 6). Do not fully tighten.
- 2. Figure 4:** Attach the top of the tank support (item 1) with two 1/2"NC x 2" bolts (item 7), four 1/2" flat washers (item 8), two 1/2" lockwashers (item 9) and two 1/2" nylon insert locknuts (item 10). Tighten all bolts (items 3 and 7).
- 3. Figure 4:** Place on each side of the parking stand (item 11) a spacer (item 12) and insert it into the tank support (item 1) and secure with two 3/8"NC x 3 3/4" bolts (item 13), four 3/8" flat washers (item 14) and two 3/8" nylon insert locknuts (item 15).
- 4. Figure 5:** Apply thread sealant to the 3/8"NPT x 3/8" barb 90° elbow (item 1). Attach the 90° elbow (item 1) to the electric pump (item 2), the barb section must point in the same direction as the one already installed on the pump.
- 5. Figure 5:** Spray soapy water on the 3/8" barb elbow end (item 1) Install the low pressure hose (item 4) on the elbow 90° 3/8"NPT x 3/8" barb (item 1). Pinch the hose collar (item 3) and bring it over the elbow barb section (item 1).
- 6. Figure 5:** Tie the low pressure hose (item 4) to the alimentation hose of the reservoir with a tie wrap (item 5).

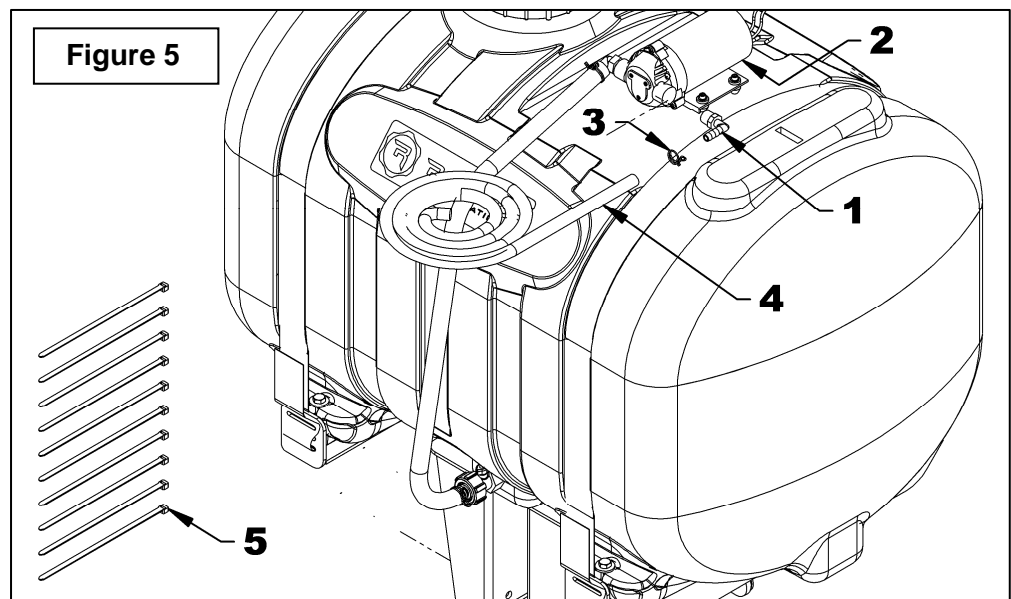
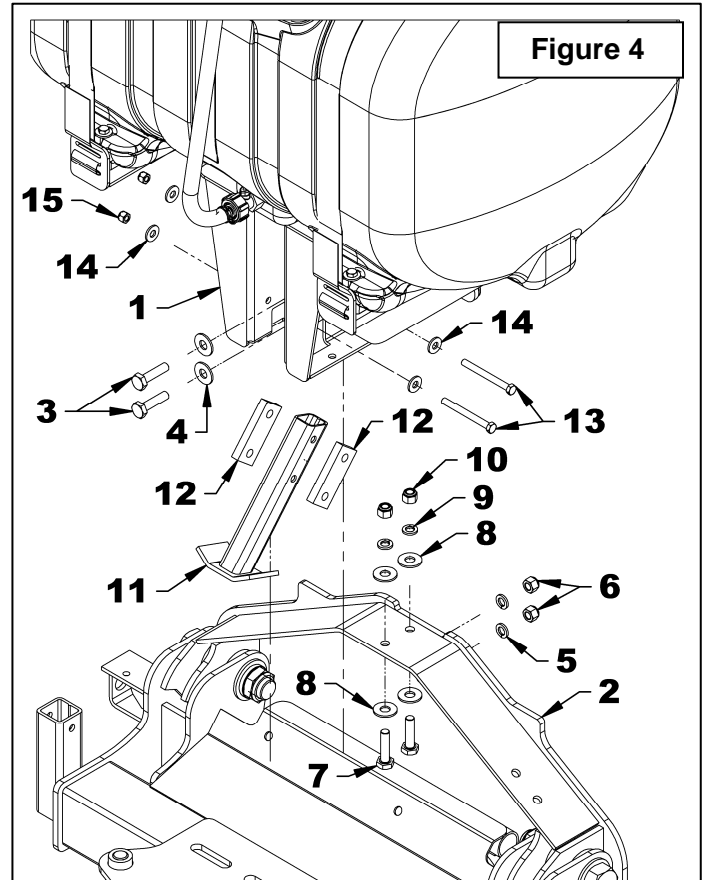

ASSEMBLY

7. **Figure 6:** Attach the low pressure hose (item 4) to the hydraulic hose (item 6) of the rotary broom motors with two nylon tie wraps (item 5) and attach it to the nozzle support (item 7) with a nylon tie wrap (item 5).
8. Cut the hose to the length required to reach the first nozzle.
9. **Figure 7:** With a pair of pliers, install the hose collar (item 2) at approximately 1 1/2" from the 1/2" low pressure hose end (item 1).
10. **Figure 7:** Spray soapy water on the 1/2" barb nozzle end (item 3). Install the low pressure hose (item 1) on the "T" nozzle barb nozzle end (item 3). Pinch the hose collar (item 6) and bring it over the "T" nozzle barb section (item 3).
11. Cut the hose needed between the next nozzles. Do the same procedure to install the hoses.

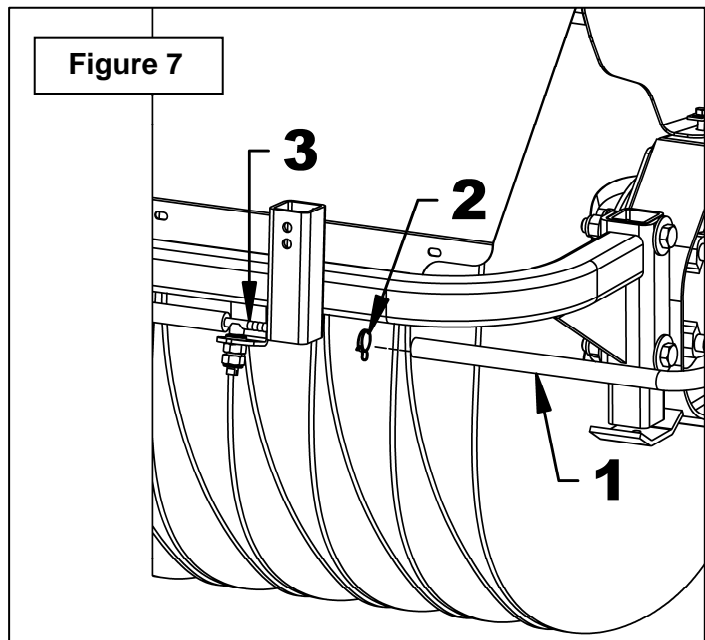
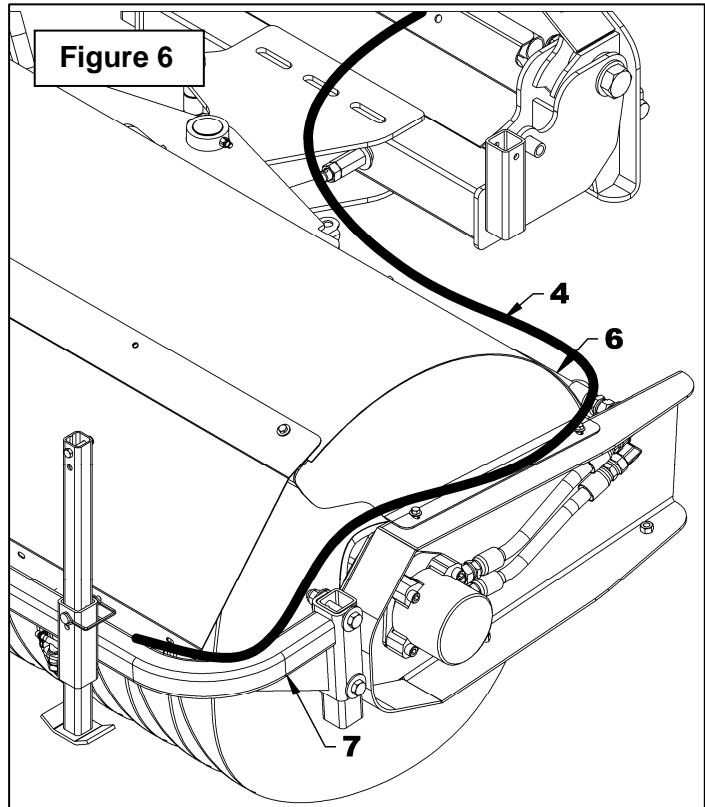

ASSEMBLY

Installation of Electric Components (Figure 8)

1. Connect the ATO fuse (item 1) in the fuse holder of the electrical harness (item 2). Connect the round connector (item A) to the positive battery terminal. Connect the round connector (item B) to the negative battery terminal.
2. Connect the relay (item 3) to the relay connector of the electrical harness (item 2).
3. Run the electrical harness (item 2) on the tractor until the operator seat area of the vehicle. Taking care that the wire is not caught by moving parts.
4. With the tap connector (item 7) connect the orange wire to the ignition signal wire.
5. Replace the broom switch box by the new switch box (item 4). Replace the broom switch by the 6 blades switch (item 5).
6. Insert the switch (item 15) in the switch (item 4). Connect the two terminals (item 8) at the end of the black and red wires (item B) of the electrical harness (item 2).
7. Bring the connector two cavities (Item E) of the electrical harness (item 2) at the vehicle quick couplers.
8. Connect the two cavities connector (item F) of the electrical harness (item 9) to two cavities connector (item E). Run the electrical harness (item 9) along the broom hydraulic hoses and secure with two nylon tie wraps (item 14).
9. Insert the thermoset splices (item 10) on the two electrical harness wires (item 9). Crimp the two flat terminals (item 11) to the wires of the electrical harness. Slide the thermoset splices (item 10) on the flat terminals (item 11) and shrink with a heat gun.
10. Connect the flat terminals (item 11) to the flat terminals (item 12) already installed on the electric pump.

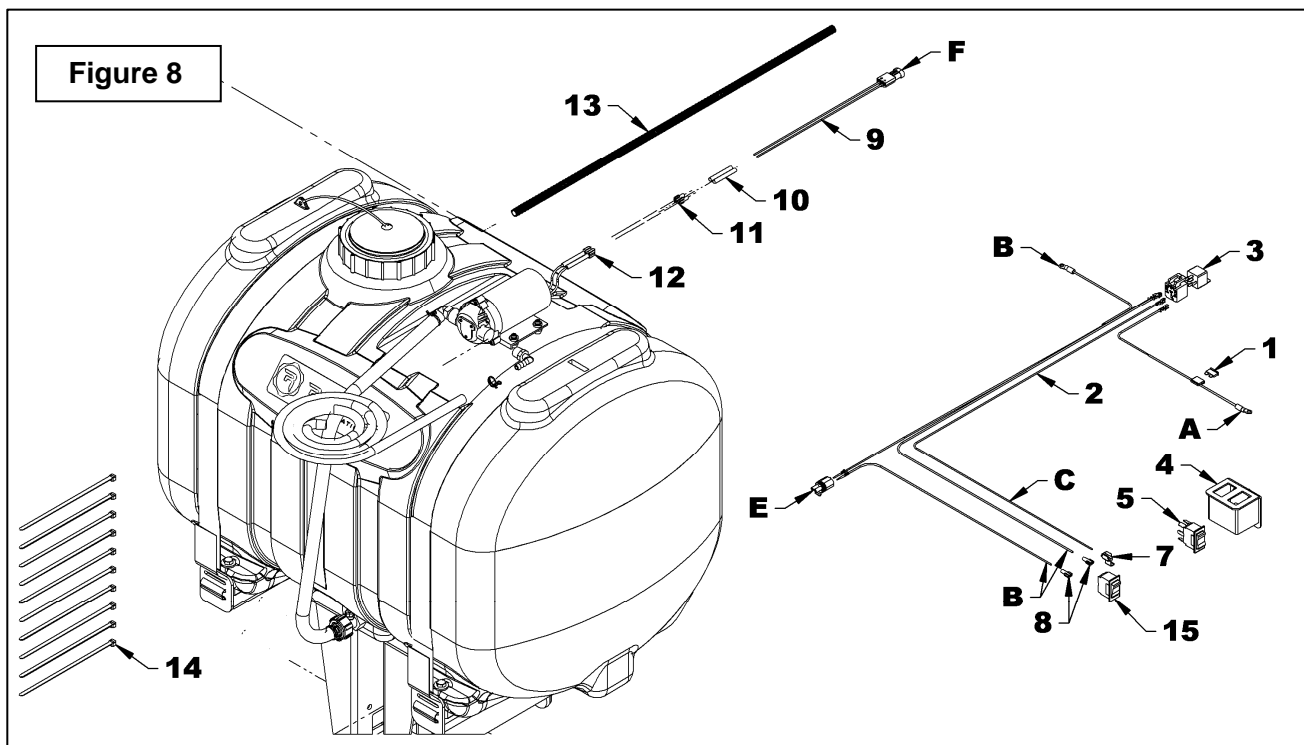

OPERATION

PREPARATION

Filling of the Tank and Preparation (Figures 9)

1. Make sure the drain cap is well tightened.
2. Unscrew the tank cap and fill the tank. Then, screw the tank cap.

COMPATIBLE PRODUCTS:

- . Water
- . De-icing and anti-icing products

IMPORTANT: DO NOT use window-washer or alcool.

3. Adjust the nylon strap tension (see "Maintenance" page 10)

IMPORTANT: When using for the first time or after the nozzle replacement, make sure the tank is filled.

4. **Figure 9a:** Open the valve at the tank output port (item 1).

5. **Figure 9b: Alignment of the nozzles:**

Set the electric pump to "ON" with the tractor switch. With an adjustable wrench (item 1), rotate the nozzles (item 2) as to set the jets straight to cover uniformly the broom width.

NOTE: It is usual that the nozzles spray larger than the broom when the brushes are new. The nozzles have been planned to cover the broom width until the brushes are worn out to maximum (see the table in "Maintenance" page 9).

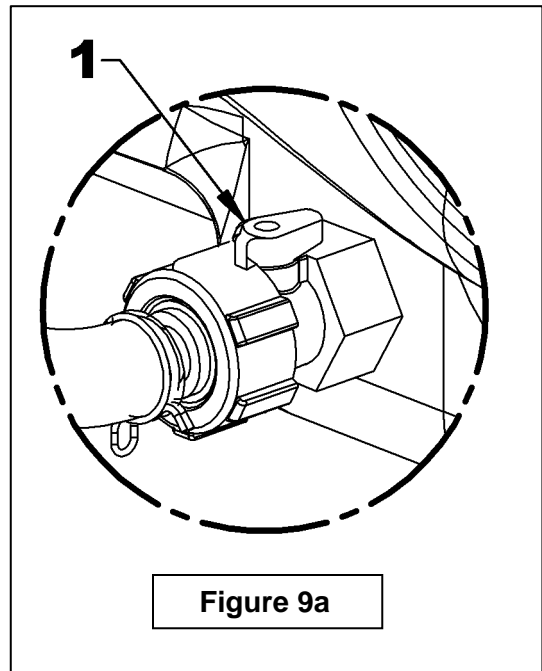

Figure 9a

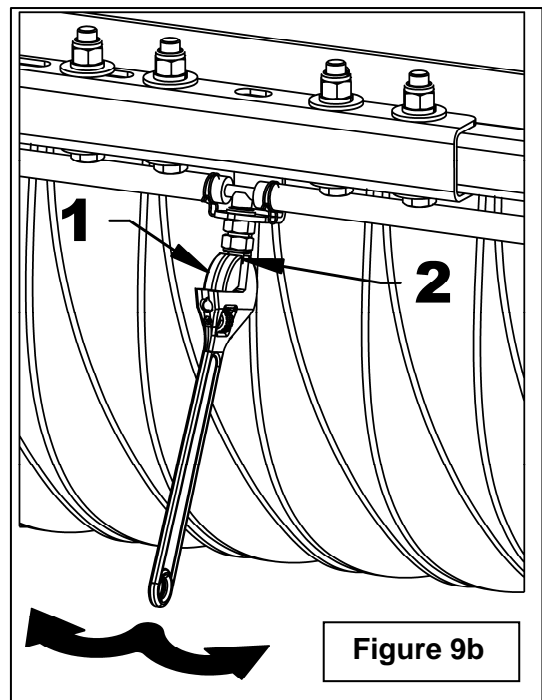

Figure 9b

OPERATION - MAINTENANCE

OPERATION

1. Fill the tank with a compatible product (see "Filling" page 8).
2. Lift the hydraulic pump and the dust suppression kit as high as possible.
3. Start the water pump with the tractor switch.
4. Adjust the tractor speed according to the dust volume, to its nature, or to the exterior conditions. The autonomy will vary according to the tractor speed.

! WARNING: Never let the machine run more than three minutes without utilization. Protect against frost.

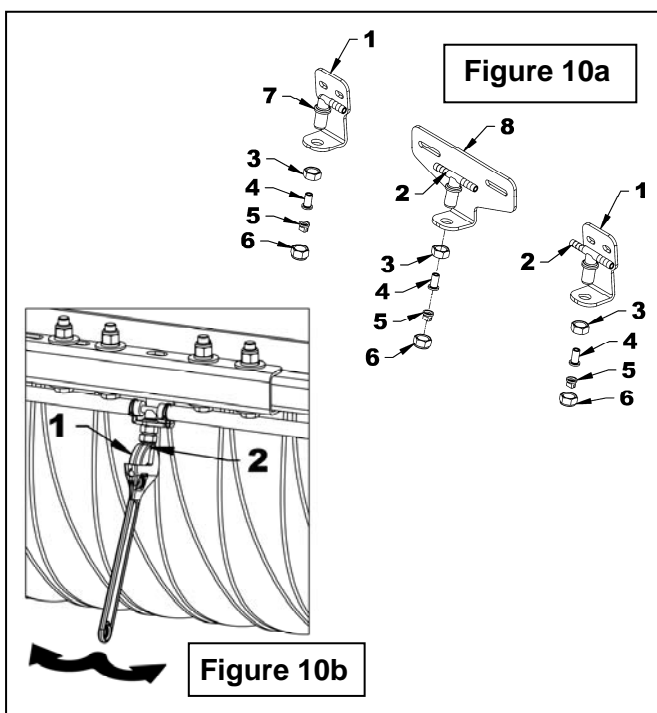

MAINTENANCE

ALWAYS USE GENUINE PARTS WHEN REPLACEMENT PARTS ARE REQUIRED.

! WARNING: Provide adequate blocking before working under the rotary broom when in raised position.

Cleaning and Replacement of the nozzles and filters (Figures 10)

1. **Figure 10a:** Remove the swivel nut (item 6) and the nozzle (item 5). Remove the anti-drop filter (item 4) from the "T" nozzle (item 2) or the 90° elbow nozzle (item 7).
2. Check nozzle and filters. Clean if necessary or replace if performance is not reached after cleaning.
3. **Figure 10a:** Insert nozzle (item 5) in the swivel nut (item 6). Insert the anti-drop filter (item 4) in the "T" nozzle (item 2) and screw the swivel nut (item 6). Reposition the nozzles as to align them parallel to the "T" or 90° elbow nozzle barb section. This is necessary to have a straight jet and parallel to the rotary broom.
4. **Nozzle alignment (Fig.10b):** Set the electric pump to "ON" with the tractor switch. With an adjustable wrench (item 1), rotate the nozzles (item 2) as to set the jets straight to cover uniformly the broom width.

NOZZLE WEARING OUT TABLE

It is usual that the nozzles spray larger than the broom when the brushes are new. The nozzles have been planned to cover the broom width until the brushes are worn out to maximum.

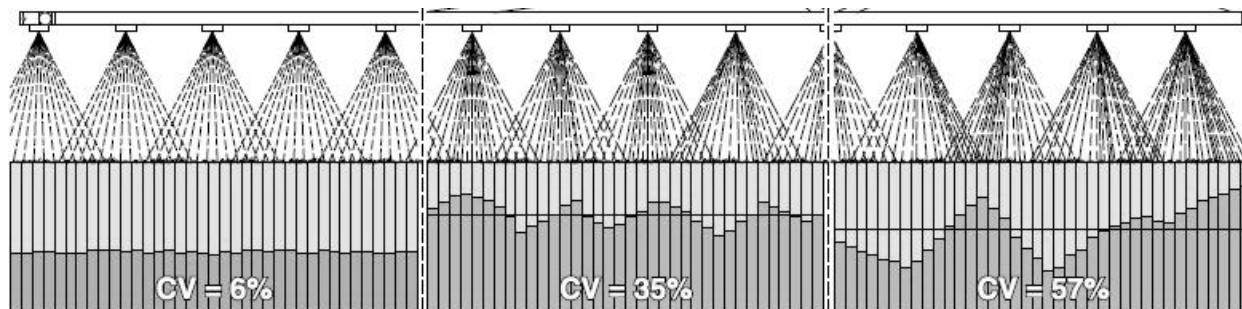

NEW NOZZLES
Even distribution when covering is acceptable.

USED NOZZLES
Output flow more important with most jet part concentrated under each nozzle.

DAMAGED NOZZLES
Very irregular distribution alternating between over dosage and under dosage.

MAINTENANCE

Strap Tension after Tank Filling (Figure 11)

After the tank filling, tighten the two straps (item 1) and tighten the two nylon insert lock nuts (item 2) with a wrench (item 3), to well sit the tank on its support.

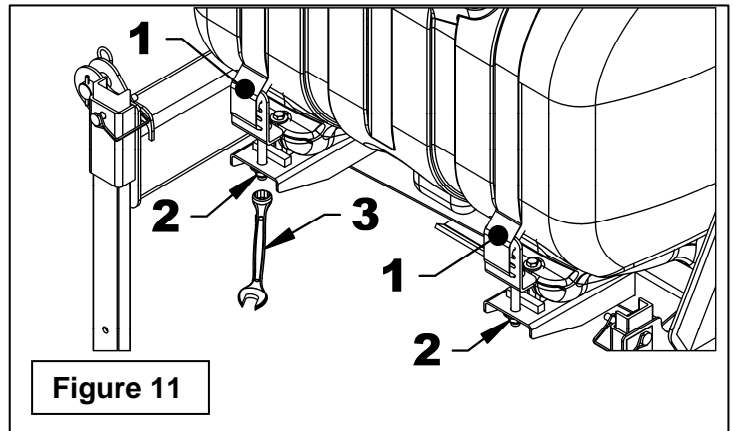

Cleaning and Replacement of the pump suction filter (Figure 12)

1. The pump suction hose is equipped with a filter. To clean it or to change the filter, first close the 1 way valve (item 1) if the tank is full. Unscrew the swivel nut (item 2) at the suction hose.
2. Remove the filter (item 3), clean or replace if necessary.
3. Look at the valve interior (item 1) and clean if necessary.
4. Install the filter with the wire nettings convex part toward the inside. Screw the swivel nut (item 2) to the 1 way valve (item 1).
5. Open the valve (item 1).

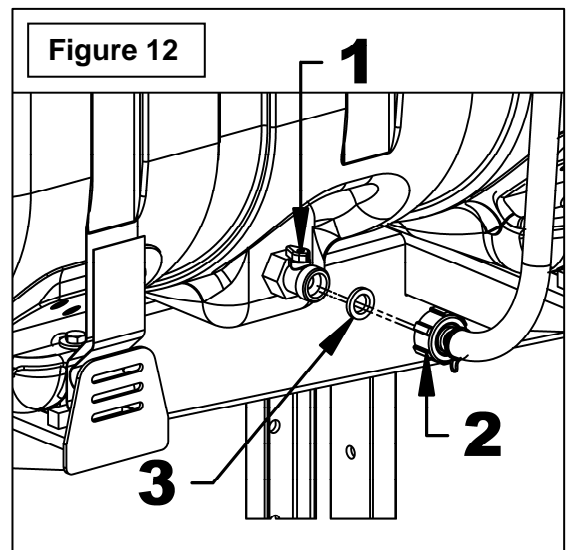

Storage

Before storing the dust suppression system, certain precautions should be taken to protect it from deterioration.

1. Clean thoroughly the dust suppression system.
2. Make all the necessary repairs.
3. Repaint all parts from which paint has worn or peeled.
4. Place the dust suppression system on its four parking stands.
5. Store in a dry place.
6. During winter and cold period, evacuate all the water from the circuit with a compressed air hose (60lb/po2, max.) connected on the pump input port.

⚠ WARNING: Always be aware that at 0°C (32°F), the dust suppression system may freeze and that by very cold weather, it may freeze in less than 5 minutes.

MAINTENANCE

TROUBLESHOOTING

The following chart serves as a guide in case of a malfunction. If the problem is not solved after taking the appropriate corrective measure, contact your dealer.

 WARNING: Several corrective measures present a certain risk, which may cause serious injuries or death. Only a qualified person, familiar with the risks associated with hydraulics, electricity and machinery should perform the repairs. Review the safety precautions at the beginning of this manual.

PROBLEM	CORRECTIVE MEASURE
1. The jets don't function well or the pressure is low.	<ul style="list-style-type: none"> - Check that the switch is to «ON». - Check that the 1 way valve is in open position. - Check that the quick couplers are connected. - Check that the hoses are not jammed. - Check if nozzles are obstructed with debris, sand. Clean or replace if needed. - Check if temperature is minus 0°C and if water is frozen inside hoses.
2. The sprayed area is uneven.	<ul style="list-style-type: none"> - Check if nozzles are damaged. Replace if needed. - Check if nozzles are well aligned. Realign if needed (see " Maintenance" p.9) - Check if nozzles are obstructed with debris, sand. Clean or replace if needed.
3. The switch is «ON» but the pump doesn't work.	<ul style="list-style-type: none"> - Check if terminals are well tight to the switch. - Check if the tractor and pump electric harness are well connected. - Check if electric harness terminals are well connected to the pump terminals. - Check the fuses. Replace if needed. - Replace the motor if needed.
4. The nozzles drip although the switch is «OFF».	<ul style="list-style-type: none"> - Check if the anti-drop filters are obstructed. Clean or replace if needed.

PERIODIC CHECKS

DESCRIPTION	TIME INTERVAL	REQUIRED CHECKS
Straps	24 hours of use	Check the straps tension.
Hoses	24 hours of use	Check the presence of leak.
Hardware	24 hours of use	Check and retighten if necessary.
Nozzles	24 hours of use	Clean or replace if necessary.
Anti-drop filters	24 hours of use	Clean or replace if necessary.
Filter (pump suction)	24 hours of use	Clean or replace if necessary.

PARTS

INTRODUCTION

All parts are illustrated in "exploded views" which show the individual parts in their normal relationship to each other. Reference numbers are used in the illustrations. These numbers correspond to those in the "Reference Number" (REF) column, and are followed by the description and quantity required.

O/L - "Obtain Locally" in the part number column indicates common hardware that is available at your local hardware supply.

Right Hand and Left Hand are determined by those seen by the conductor standing behind the equipment.

The manufacturer reserves the rights to change, modify, or eliminate from time to time, for technical or other reasons, certain or all data, specifications, or the product or products themselves, without any liability or obligation.

The parts listed here are available through your local dealer.

PARTS

TANK COMPONENTS

REF.	DESCRIPTION	QTY	PART #
1	Tank Cap	1	3500006
2	Tank Cap Tie	1	3500007
3	Drain Plug	1	3500003
4	Drain Plug Clip	1	3500004
5	Rubber Flat Washer	1	3500005



PARTS

TANK AND SUPPORT

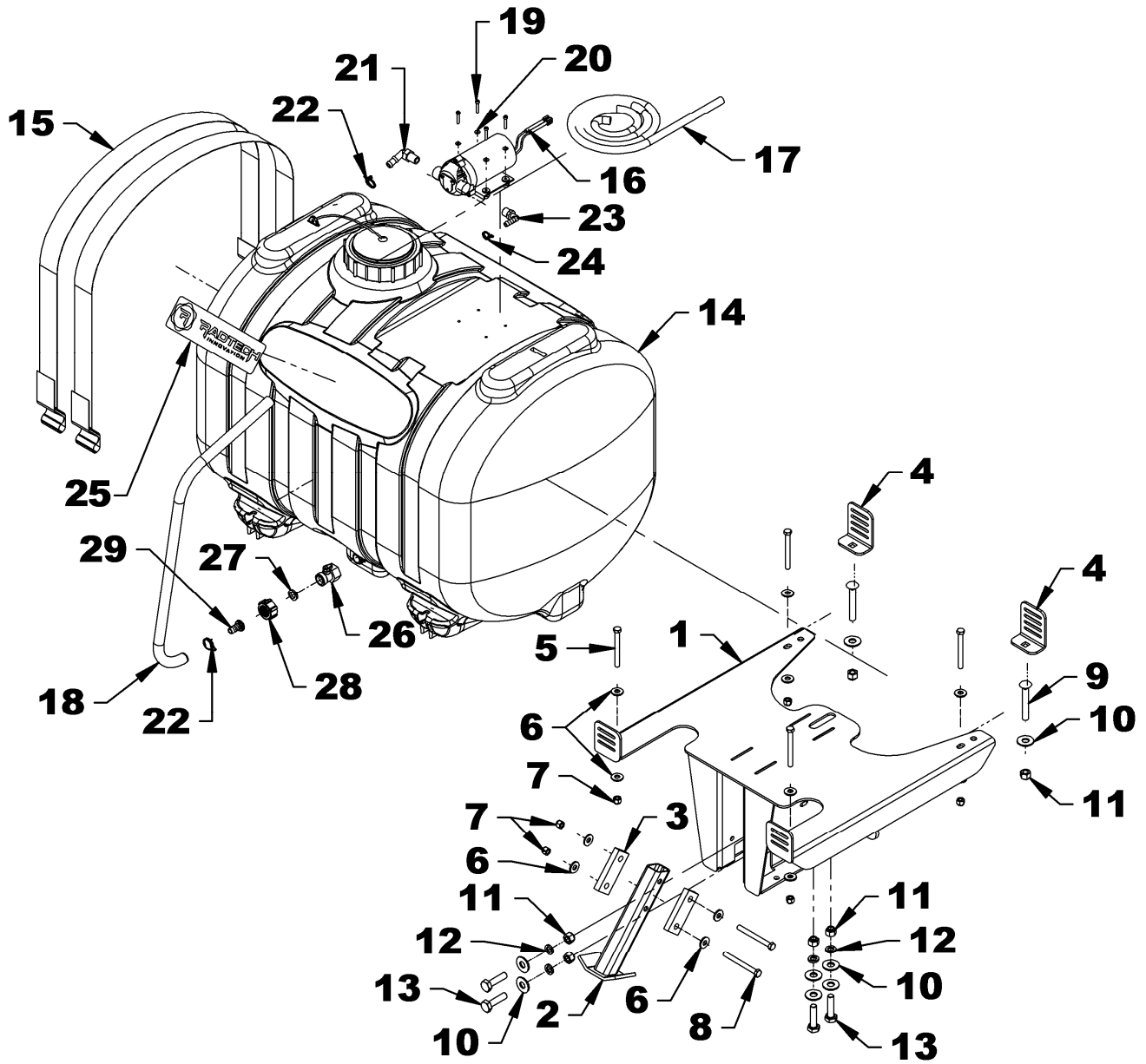

PARTS

TANK AND SUPPORT

REF.	DESCRIPTION	QTY	PART #
1	Tank support	1	669409
2	Parking stand	1	669410
3	Shim	2	669411
4	Strap fastener	2	669412
5	Bolt hex 3/8"NC x 3 1/2" lg PTD	4	0100047
6	Flat washer 3/8" (7/16" hole) PTD	12	1400004
7	Nylon insert locknut 3/8"NC PTD	6	1000006
8	Bolt hex 3/8"NC x 3 3/4" gr.5 PTD	2	0100048
9	Bolt carriage 1/2"NC x 3 1/2" PTD	2	0300027
10	Flat washer 1/2" (9/16" hole) PTD	8	1400006
11	Nylon insert locknut 1/2"NC PTD	6	1000011
12	Lockwasher 1/2" PTD	4	1200006
13	Bolt hex 1/2"NC x 2" lg PTD	4	0100073
14	Tank 60 gallons	1	3500002
15	Strap nylon	2	669418
16	Pump electric 1.8 GPM 12V	1	669430
17	Hose low pressure 3/8" x 192"	1	669417
18	Hose low pressure 1/2" x 32"	1	669416
19	Allen socket head cap screw 10-24 x 1"	4	0800009
20	Flat washer #8 (3/16" hole) PTD	4	1400001
21	Elbow 90° - 3/8"NPT x 1/2" barb	1	3500010
22	Hose collar 13/16"	2	4200038
23	Elbow 90° - 3/8"NPT x 3/8" barb	1	3500011
24	Hose collar 5/8"	8	4200039
25	Decal RADTECH Innovation	1	2500762
26	Valve 1 way - 3/4"GHT fem x 3/4"GHT male	1	3500015
27	Flat washer rubber 50 mesh grid	1	3500014
28	Nut 3/4"GHT	1	3500013
29	Flat seat 1/2"barb	1	3500012

PARTS

NOZZLES SUPPORTS

REF.	DESCRIPTION	QTY	PART #
1	Nozzle Support	4	669414
2	Nozzle Support - large (for 60" rotary broom)	1	669415
3	"T" 11/16"UN male x 3/8" barb x 3/8" barb (nut included)	3	3500019
4	Elbow 90° 11/16"UN male x 3/8" barb (nut included)	1	3500018
5	Hex nut 11/16"UN (included in 35000018 and 3500019)	4	3500020
6	Filter with relief valve grid 50 mesh	4	3500016
7	Nozzle No4 - 110°	4	3500008
8	Swivel nut 11/16"UN	4	3500017

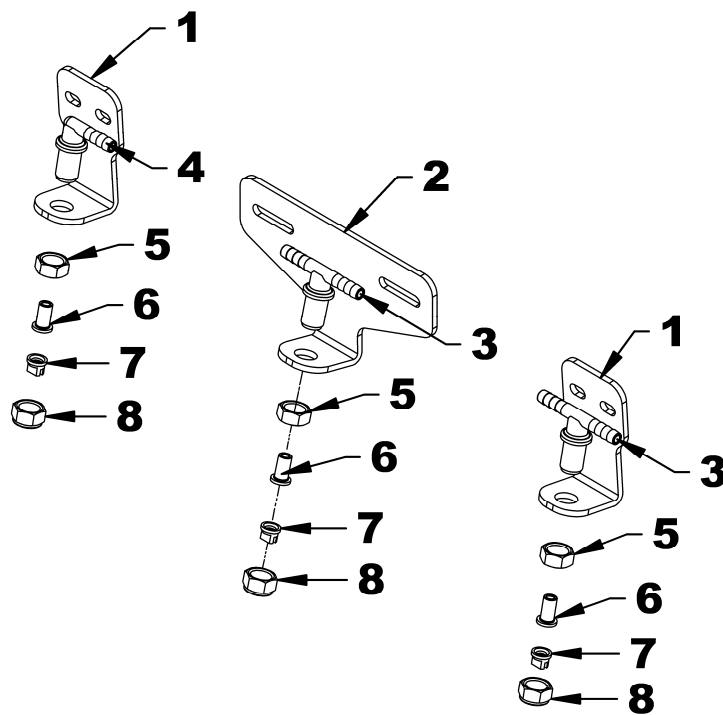

PARTS

ELECTRIC COMPONENTS

REF.	DESCRIPTION	QTY	PART #
1	Switch box & bracket ass'y	1	669285
2	Wiring harness	1	4000080
3	Wiring harness - power supply	1	4000081
4	Relay 12V plastic 30A SPDT	1	4000028
5	Fuse ATO 10amp	1	4000040
6	Terminal female flat 1/4" 16-14GA nylon insulated	4	660301
7	Tap connector	1	656665
8	Thermoset splices 1/4" x 2"	2	666485
9	Switch 2 blades	1	4000050
10	Switch 6 blades	1	4000072
11	Loom 3/8" x 480"	1	
12	Nylon tie wrap	10	2100011

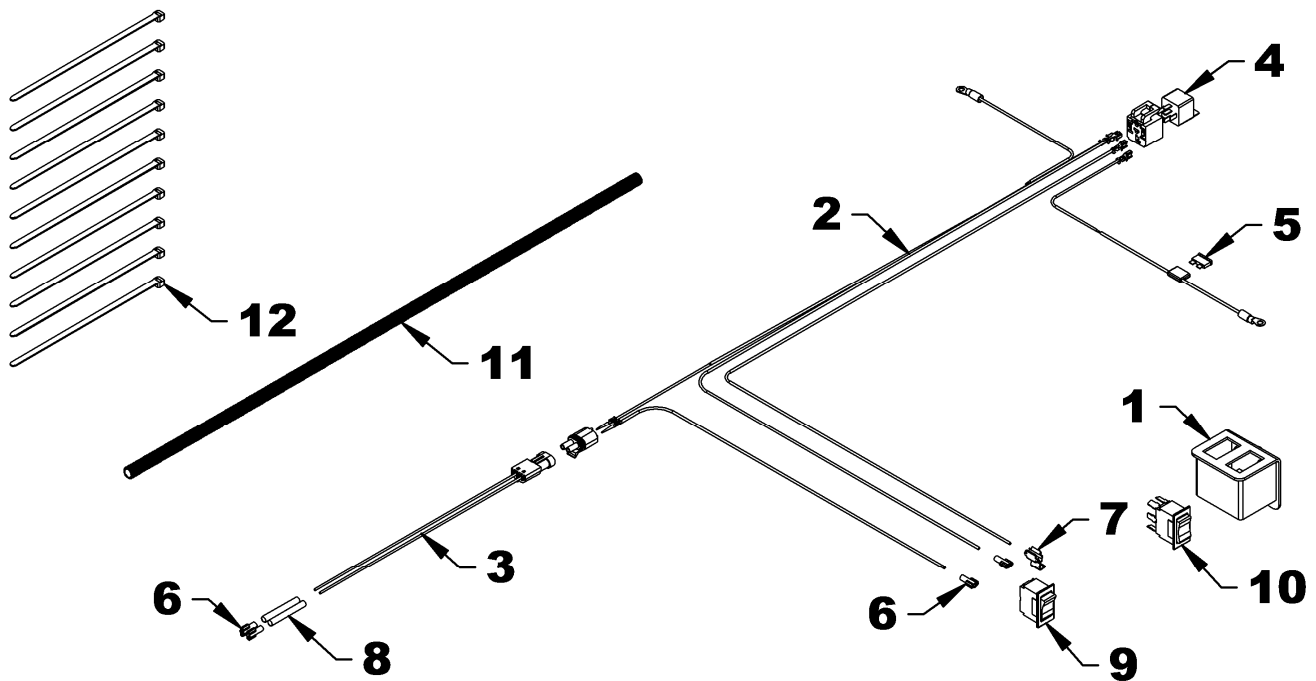

TORQUE SPECIFICATION TABLE

GENERAL SPECIFICATION TABLE

Use the following torques when special torques are not given

NOTE: These values apply to fasteners as received from supplier, dry, or when lubricated with normal engine oil. They do not apply if special graphited or moly disulfide greases or other extreme pressure lubricants are used. This applies to both UNF and UNC threads.

BOLT HEAD IDENTIFICATION MARKS AS PER GRADE NOTE: MANUFACTURING MARKS WILL VARY.													
		Torque		Torque		Torque		Torque					
BOLT SIZES		Pounds-Foot		Newtons-Meter		Pounds-Foot		Newtons-Meter		Pounds-Foot		Newtons-Meter	
Inches	Millimeters	MIN.	MAX.	MIN.	MAX.	MIN.	MAX.	MIN.	MAX.	MIN.	MAX.	MIN.	MAX.
1/4	6.35	5	6	6.8	8.13	9	11.0	12.2	14.9	12	15	16.3	30.3
5/16	7.94	10	12	13.6	16.3	17	20.5	23.1	27.8	24	29	32.5	39.3
3/8	9.53	20	23	27.1	31.2	35	42.0	47.5	57.0	45	54	61.0	73.2
7/16	11.11	25	30	40.7	47.4	54	64.0	73.2	86.8	70	84	94.9	113.9
1/2	12.70	45	52	61.0	70.5	80	96.0	108.5	130.2	110	132	149.2	179.0
9/16	14.29	65	75	88.1	101.6	110	132.0	149.2	179.0	160	192	217.0	260.4
5/8	15.88	95	105	128.7	142.3	150	180	203.4	244.1	220	264	298.3	358.0
3/4	19.05	150	185	203.3	250.7	270	324	366.1	439.3	380	456	515.3	618.3
7/8	22.23	160	200	216.8	271.0	400	480	542.4	650.9	600	720	813.6	976.3
1	25.40	250	300	338.8	406.5	580	696	786.5	943.8	900	1080	1220.4	1464.5
1 1/8	25.58	-	-	-	-	800	880	1084.8	1193.3	1280	1440	1735.7	1952.6
1 1/4	31.75	-	-	-	-	1120	1240	1518.7	1681.4	1820	2000	2467.9	2712.0
1 3/8	34.93	-	-	-	-	1460	1680	1979.8	2278.1	2380	2720	3227.3	3688.3
1 1/2	38.10	-	-	-	-	1940	2200	2630.6	2983.2	3160	3560	4285.0	4827.4

METRIC BOLT TORQUE SPECIFICATIONS

Size of screw	Grade No.	Pitch (mm)	Coarse thread				Fine Thread				
			Pounds-Foot		Newtons-Meter		Pitch (mm)	Pounds-Foot		Newtons-Meter	
			MIN.	MAX.	MIN.	MAX.		MIN.	MAX.	MIN.	MAX.
M6	4T	1.0	3.6	5.8	4.9	7.9	-	-	-	-	-
	7T		5.8	9.4	7.9	12.7		-	-	-	-
	8T		7.2	10	9.8	13.6		-	-	-	-
M8	4T	1.25	7.2	14	9.8	19.0	1.0	12	17	16.3	23.0
	7T		17	22	23	29.8		19	27	25.7	36.6
	8T		20	26	27.1	35.2		22	31	29.8	42
M10	4T	1.5	20	25	27.1	33.9	1.25	20	29	27.1	39.3
	7T		34	40	46.1	54.2		35	47	47.4	63.7
	8T		38	46	51.5	62.3		40	52	54.2	70.5
M12	4T	1.75	28	34	37.9	46.1	1.25	31	41	42	55.6
	7T		51	59	69.1	79.9		56	68	75.9	92.1
	8T		57	66	77.2	89.4		62	75	84	101.6
M14	4T	2.0	49	56	66.4	75.9	1.5	52	64	70.5	86.7
	7T		81	93	109.8	126		90	106	122	143.6
	8T		96	109	130.1	147.7		107	124	145	168
M16	4T	2.0	67	77	90.8	104.3	1.5	69	83	93.5	112.5
	7T		116	130	157.2	176.2		120	138	162.6	187
	8T		129	145	174.8	196.5		140	158	189.7	214.1
M18	4T	2.0	88	100	119.2	136	1.5	100	117	136	158.5
	7T		150	168	203.3	227.6		177	199	239.8	269.6
	8T		175	194	237.1	262.9		202	231	273.7	313
M20	4T	2.5	108	130	146.3	176.2	1.5	132	150	178.9	203.3
	7T		186	205	252	277.8		206	242	279.1	327.9
	8T		213	249	288.6	337.4		246	289	333.3	391.6

Manufactured by:



RADTECH

Division of RAD Technologies Inc.

2835, Chemin de l'Aéroport

Thetford Mines, Québec, Canada, G6G 5R7

Tel.: (418) 338-4499 - Fax: (418) 338-6090

e-mail : radtech@radinter.com

Internet : www.radinter.com

Printed in Canada