

**INSTRUCTION SHEET**
**LAWN DETHATCHING WHEEL KIT**
**INSTALLATION**

1. **Figure 1:** Install the left bracket and the right bracket (item 1) on each side of the housing using seven 3/8" NC x 3/4" hex. serrated flange bolts (item 3) and 3/8"NC hex. nuts (item 4).
2. **Figure 1-2:** Insert the tube of the left side caster wheel (fig. 1, item 2) into the wheel bracket (fig. 1, item 1) and secure in place with a square lock pin (fig. 2, item 1).
3. Repeat the same procedure for the right wheel.
4. **Figure 2:** To adjust the height of the wheel (1/4" at a time minimum), remove the square lock pin (item 1), slide the inner tube upward or downward, as needed, and reinsert the square lock pin in the visible hole.

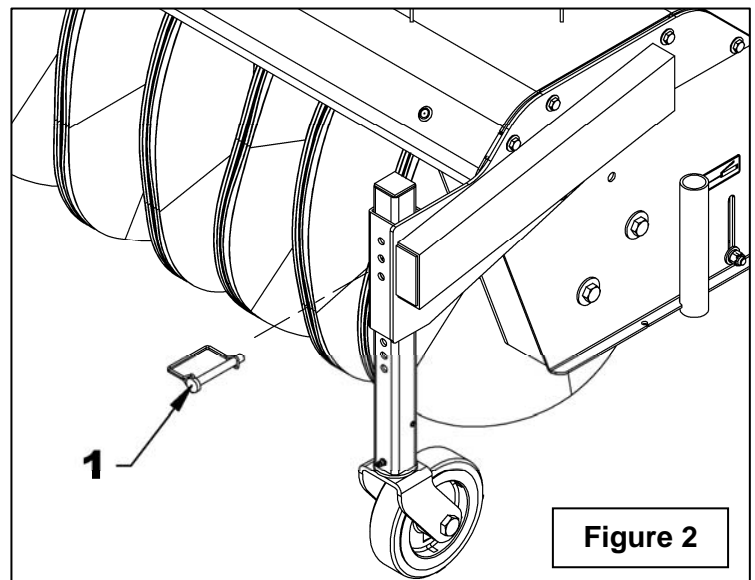
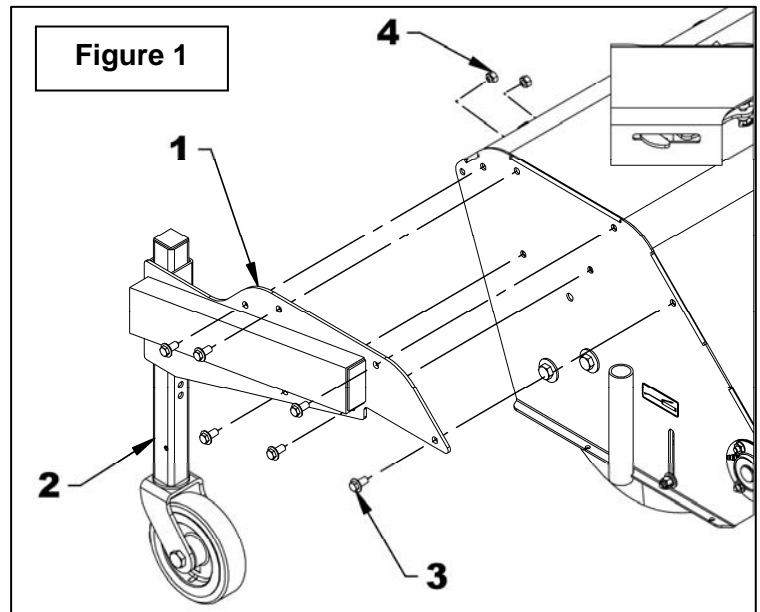

INSTRUCTION SHEET

LAWN DETHATCHING WHEEL KIT

**PARTS**

REF.	DESCRIPTION	QTY	PART #
1	Right bracket	1	665517
2	Left bracket	1	665516
3	Adjustment tube	2	665518
4	Wheel bushing	2	660948
5	Wheel bracket	2	669838
6	Wheel 6" diam. X 2"	2	661306
	- Bearing repair kit for wheel 6"	1	4300029
7	Grease fitting 1/4" NF	2	654106
8	Serrated flange bolt 3/8" NC x 3/4"lg., gr. 2, PTD	14	0200066
9	Nut hex. 3/8"NC PTD	14	0900003
10	Roll pin 1/4" x 1 1/2", black	2	1600016
11	Flat washer 13/16" hole, PTD	2	1400010
12	Bolt hex 5/8"NC x 3 3/4" lg gr.5 PTD	2	0100102
13	Nylon insert locknut 1/2"NC, PTD	2	1000012
14	Square wire lock pin 3/8" x 2 1/2"	2	1900008

