



INSTRUCTION SHEET

8236 – 3 POINT HITCH - CAT.1 & 2

INSTALLATION

NOTE: When installing the 8236 hitch kit, take care to choose the figures that correspond to your tractor's category (1 or 2).

- Figure 1:** As shown, attach the 3 point hitch upper support (item 1) to the universal hitch (item 2) with two 1/2"NC x 1 3/4" lg. hex. bolts (item 3), 9/16" hole flat washers (item 4), 1/2" lockwashers (item 5) and 1/2"NC nylon insert locknuts (item 6). The upper support (item 1) must be placed at the end of the slotted holes towards the front of the broom.
- Figure 1:** As shown, attach the two 3 point hitch lower supports (item 7) to the universal hitch (item 2) with four 5/8"NC x 2" lg. hex. bolts (item 8), 5/8" lockwashers (item 9) and 5/8"NC nylon insert locknuts (item 10).
- Figure 1:** As shown, according to the category, attach the cat. 1 & 2 pins (item 11) on the 3 point hitch lower supports (item 7) with lockwashers (item 12) and hex. nuts (item 13). The 7/16" linchpins (item 14) will be used to attach the broom on the tractor 3 point hitch.



WARNING: To avoid serious personal injuries: Before getting off the tractor: Park the tractor near of broom on level ground, place the transmission in neutral, set the parking brake, disengage the driving system, place all levers including auxiliary control levers in neutral, shut off the engine and remove the ignition key.

IMPORTANT: Make sure the "T" pin (fig. 2, item 1) is locked in the broom housing to prevent the female hitch from bouncing and to facilitate installation.

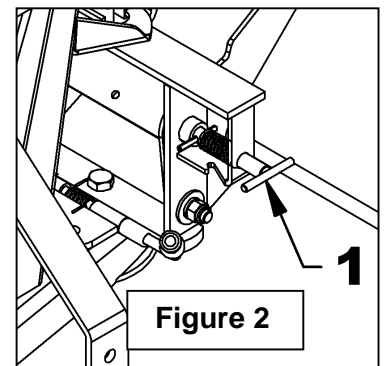
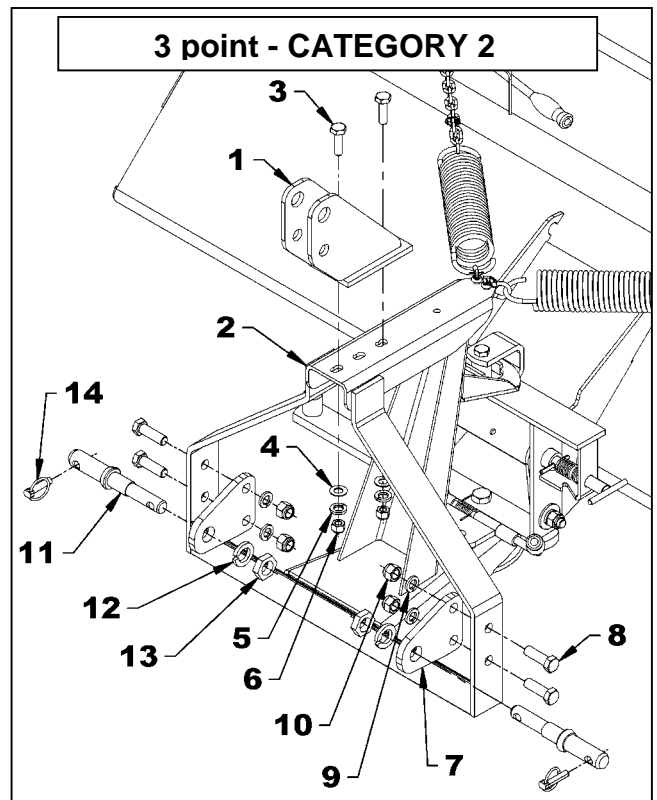
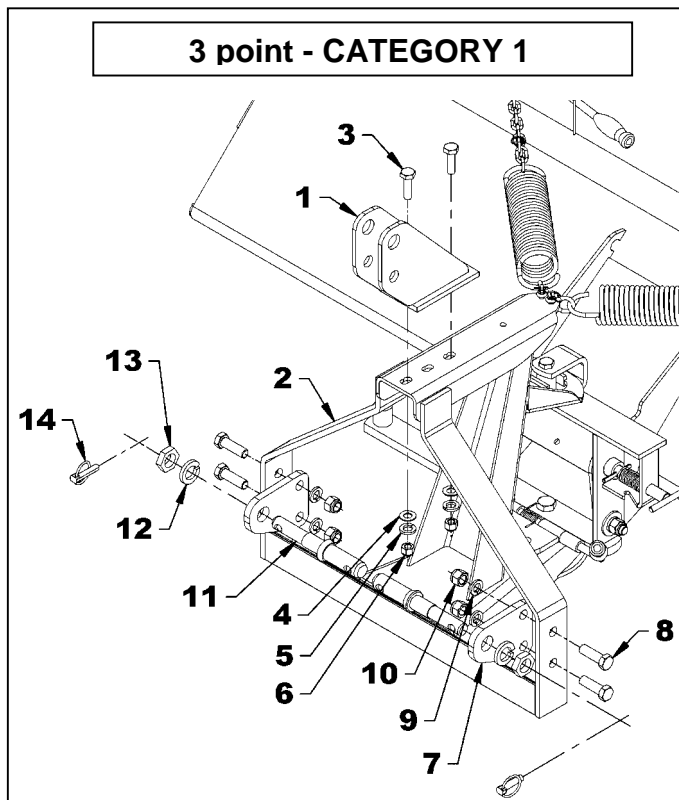

Figure 1





INSTRUCTION SHEET

8236 – 3 POINT HITCH - CAT.1 & 2

Hoses & Broom Installation on Tractor

1. **Figure 3:** As shown, attach the two broom hoses (item 1) on the universal hitch (item 2) with the hose clamp (item 3), 3/8"NC x 1 1/2" lg. hex. bolt (item 4), 3/8" lockwasher (item 5) and 3/8" NC hex. nut (item 6). Before tightening the hose clamp, orientate the broom in all directions possible (up and down, left and right, etc.) and make sure the hoses have enough lose to not get caught between the mobile parts of the broom or the tractor.
2. **Figure 4:** With three nylon tie wraps (item 1), attach together the hoses (item 2) to the places indicated by the arrows on the figure. The two other nylon tie wraps might be used to roll and attach together the hoses excess.
3. **Figure 5:** Attach the broom to the tractor 3 point hitch. Use the attaching points shown by the arrows on the figure according to the appropriated category.
4. Adjust the upper hith of the tractor 3 point hitch until the broom hitch is at 90° with the ground. See figure 6.
5. Adjust the anti-sway arms of the tractor 3 point hitch to eliminate the lateral movements of the broom.



WARNING: To avoid serious personal injury. Escaping hydraulic/diesel fluid under pressure can penetrate the skin causing serious injury.

- Do not use your hands to check for leaks. Use a piece of cardboard or paper to search for leaks.

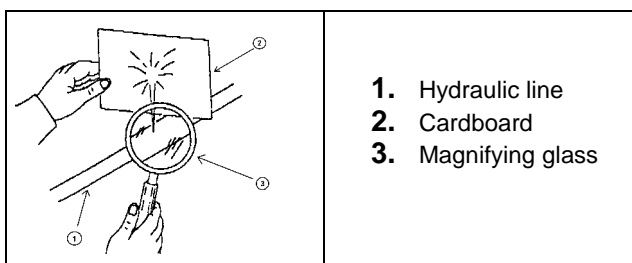

- Stop engine and relieve pressure before connecting or disconnecting lines.
- Tighten all connections before starting engine or pressurizing lines.

If any fluid is injected into the skin, obtain medical attention immediately or gangrene may result.

Figure 3

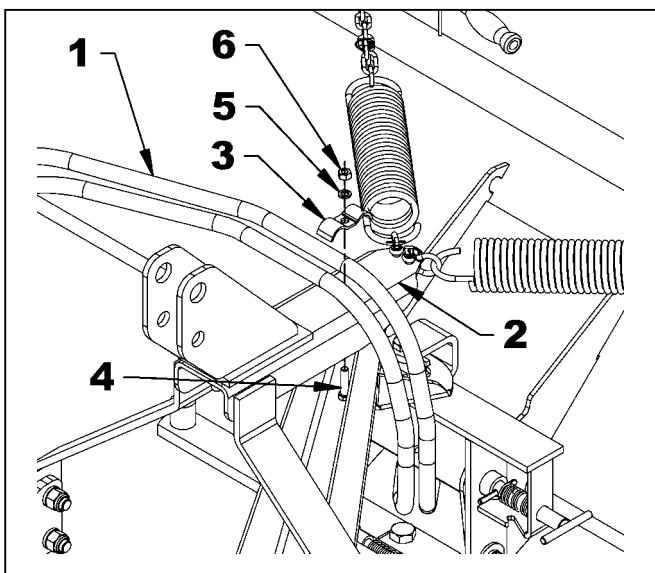
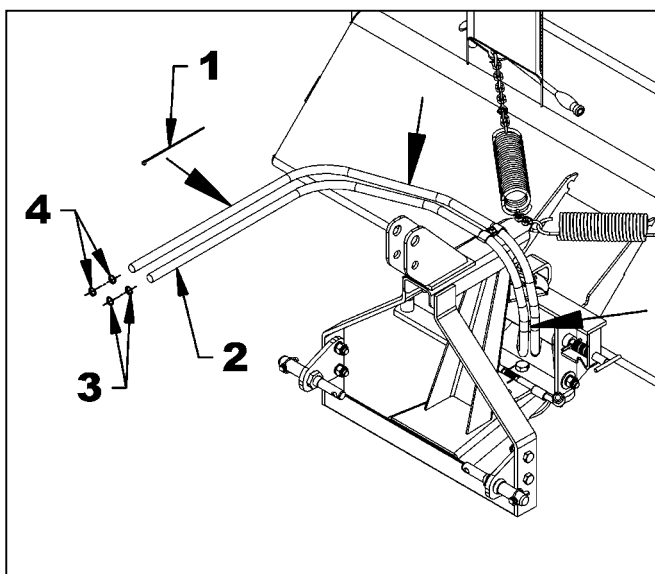

Figure 4





INSTRUCTION SHEET

6. Connect hoses to the tractor valve.

NOTE: the hydraulic connectors that attach the hoses to the tractor valve, front loader or skid steer are not included with this kit.

Furthermore, depending on the location of the valve on the tractor, front loader or skid steer, the hoses may not be long enough. If that is the case, obtain the missing hose length. Note that the fitting on the broom hydraulic hoses are 1/2" NPT rigid male.

7. **Figure 4:** Install a red identification ring (item 3) on the connector of a hose and the other red identification ring (item 3) on the related hydraulic output of the tractor valve. Install a blue identification ring (item 4) on the connector of the second hose and the other blue identification ring (item 4) on the second hydraulic output of the tractor valve.
8. When the engine is started and the oil has run in the hydraulic circuit, turn off the engine, check the oil level and add some if needed.

NOTE: If the broom rotation movement is not as desired, reverse the quick couplers on the valve and associate the colored plastic rings (fig.4, items 3 and 4).

8236 – 3 POINT HITCH - CAT.1 & 2

IMPORTANT: To avoid damaging the broom when in use, make sure it is in the unlocked position by pulling the "T" pin handle (fig. 2, item 1) and engaging the spring pin in the notch of the broom pivot. The broom should only be locked during transport, installation and removal and when changing the brush.



ATTENTION: To avoid personal injuries or important damages, always make sure to keep a 90° angle between the hitch and the ground (figure 6).

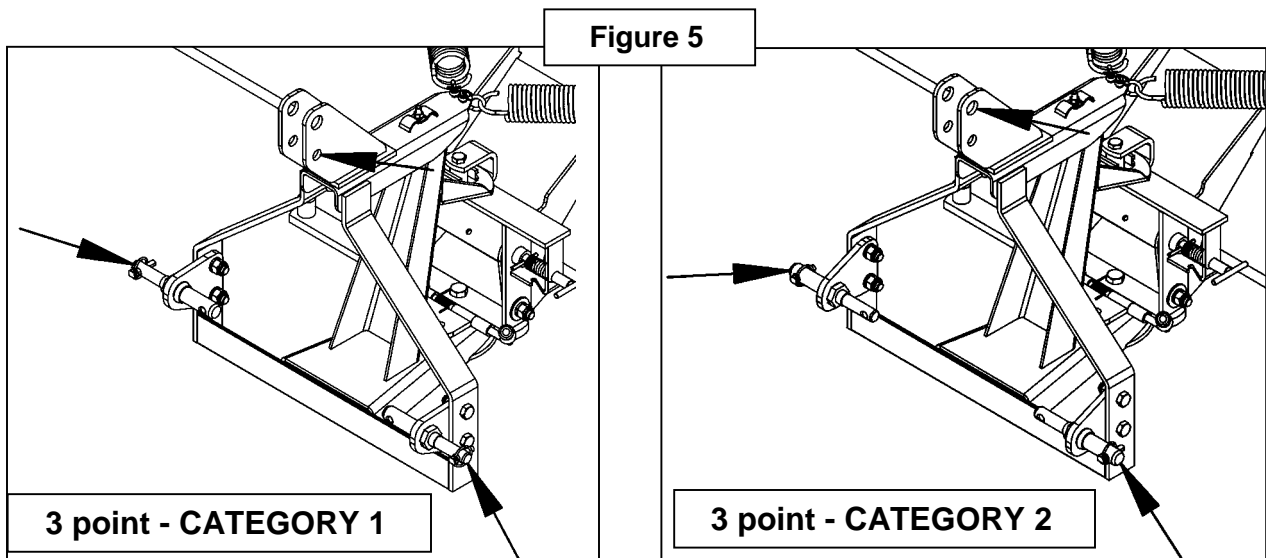
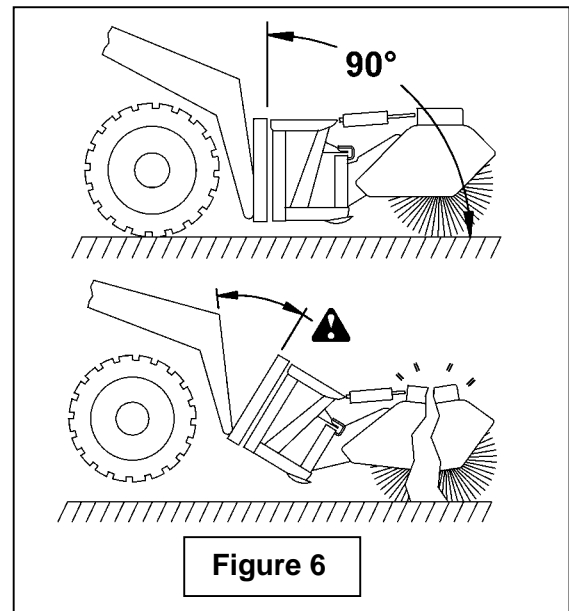



INSTRUCTION SHEET

8236 – 3 POINT HITCH - CAT.1 & 2

3 POINT HITCH CAT.1 & 2

REF.	DESCRIPTION	QTY	PART #
1	Upper support	1	667324
2	Lower support	2	667325
3	Pin cat. 1 & 2 PTD (w/ Lockwasher & nut)	2	654204
4	Linchpin 7/16" PTD	2	1900003

