



INSTRUCTION SHEET

8106A REAR HYDRAULIC BLADE

Rear Hydraulic Blade 8106A Installation (Optional) (Figure below)

1. Install the chosen cutting edge (items 5 or 6) between the blade (item 1) and the support bracket (item 7) with ten 1/2" x 2 1/2" carriage bolts, lockwashers and nuts (items 8-9-10).
2. Attach the blade (item 1) to the snowblower, running the cylinders under the snowblower reinforcements, using four 5/8" x 2 1/2" bolts and stover nuts (items 3-4).
3. Make sure that the cylinder ports (item 11) are facing the outside before attaching.

Adjustment of Tivar Cutting Edge for Rear Hydraulic Blade

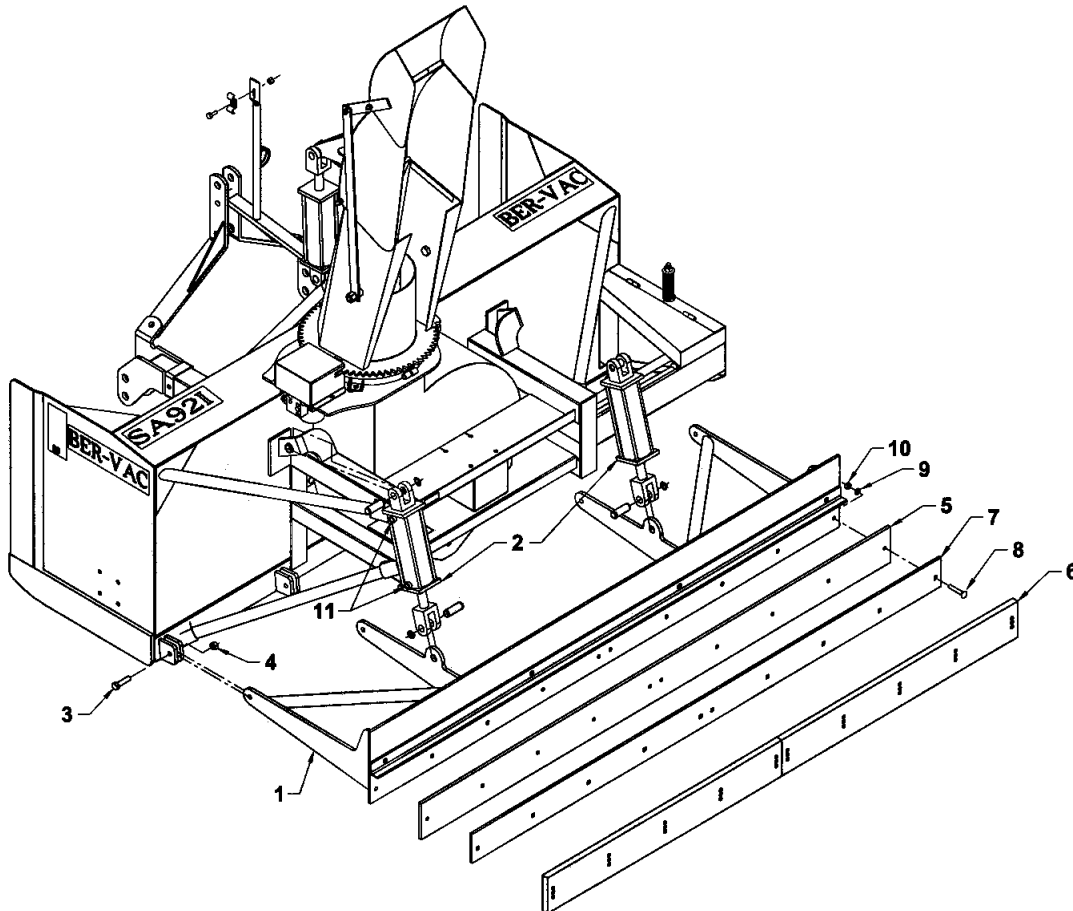
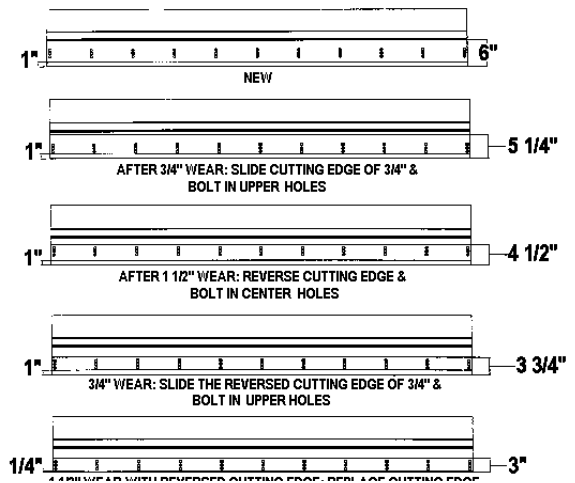



INSTRUCTION SHEET

8106A REAR HYDRAULIC BLADE

REAR HYDRAULIC BLADE 8106A (OPTION)

| REF. | DESCRIPTION | QTY. | PART # |
|------|---|------|-------------|
| 1 | Rear blade | 1 | 665278 |
| 2 | Cutting edge support bracket | 1 | 665280 |
| 3 | Cylinder and pins 3" x 8" | 2 | 654129 |
| | Seal kit | 1 | 664176 |
| 4 | Stover nut 5/8" NC | 4 | O/L |
| 5 | Hex. bolt 5/8" NC x 2 1/2" | 4 | O/L |
| 6 | Carriage bolt 1/2" NC x 1 1/2" | 10 | O/L |
| 7 | Lockwasher 1/2" | 10 | O/L |
| 8 | Hex. nut 1/2" NC | 10 | O/L |
| 9 | Steel cutting edge optional | 1 | 8123 |
| 10 | Tivar cutting edge optional (2 sections) | 1 | 8124 |

*O/L = Obtain Locally

