



# INSTRUCTION SHEET

# 8106 REAR HYDRAULIC BLADE

## Rear Hydraulic Blade 8106 Installation (Optional)

1. Install the chosen cutting edge (items 5 or 6) between the blade (item 1) and the support bracket (item 7) with ten 1/2" x 2 1/2" carriage bolts, locwashers and nuts (items 8-9-10).
2. Attach the blade (item 1) to the snowblower, running the cylinders under the snowblower reinforcements, using four 5/8" x 2 1/2" bolts and stover nuts (items 3-4).
3. Make sure that the cylinder ports (item 11) are facing the outside before attaching.

## Adjustment of Tivar Cutting Edge for Rear Hydraulic Blade

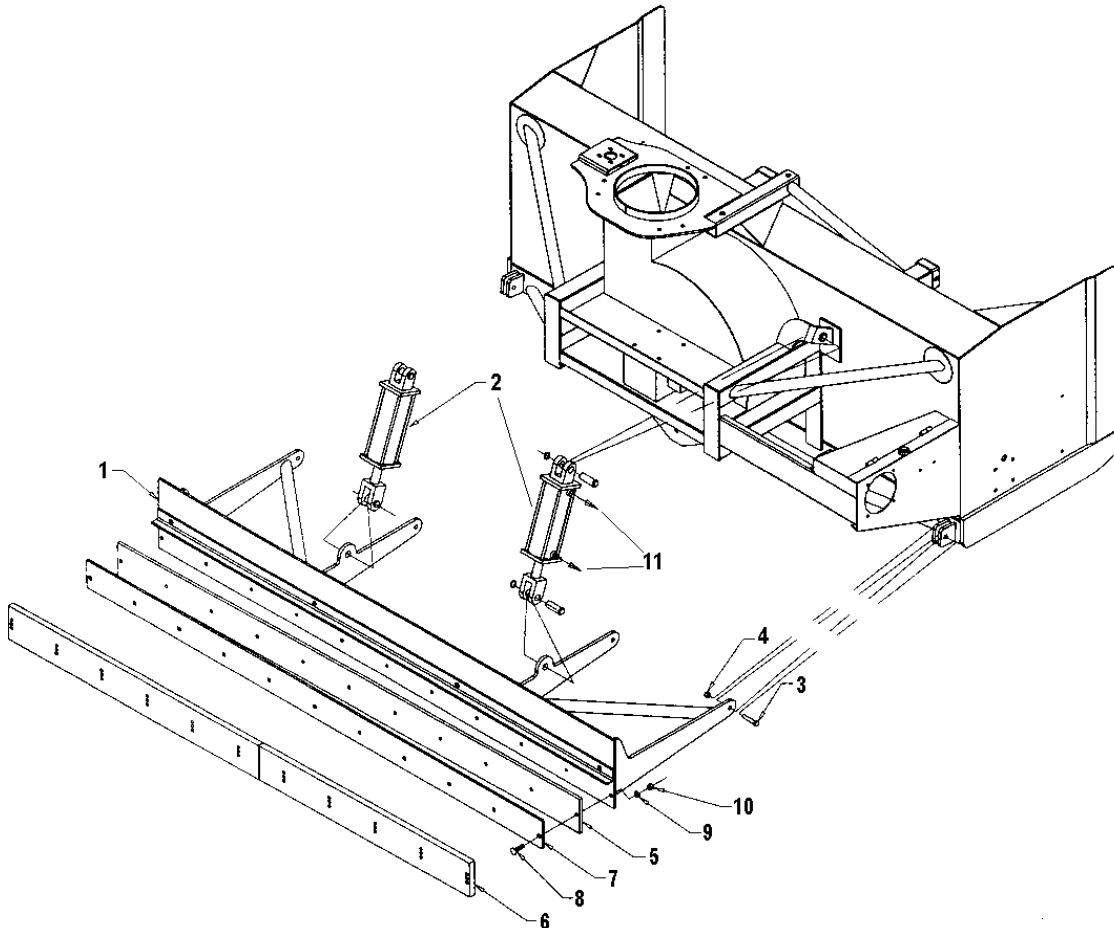
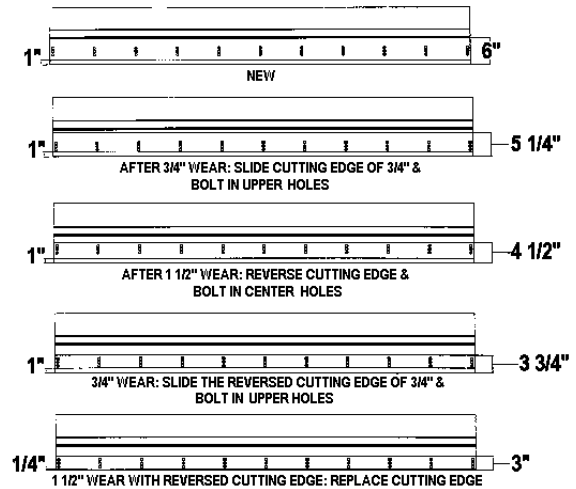



# INSTRUCTION SHEET

# 8106 REAR HYDRAULIC BLADE

## REAR HYDRAULIC BLADE 8106 (OPTION)

REF.	DESCRIPTION	QTY.	PART #
1	Rear blade	1	665278
2	Cutting edge support bracket	1	665280
3	Carriage bolt 1/2" NC x 1 1/2"	10	O/L
4	Lockwasher 1/2"	10	O/L
5	Hex. nut 1/2" NC	10	O/L
6	Hex. bolt 5/8" NC x 2 1/2"	4	O/L
7	Stover nut 5/8" NC	4	O/L
8	Cylinder and pins 3" x 8"	2	654129
9	<b>Steel cutting edge optional</b>	1	<b>8123</b>
10	<b>Tivar cutting edge optional (2 sections)</b>	1	<b>8124</b>

