

Hydraulic Rotation with Cylinder - Kit 8046 (Figure below ↓)

1. Attach the chute with the retaining plates (and spacers for SA74 & SA80). Fasten with six 1/2"NC x 1 1/4" bolts (item 11) and serrated flange nuts (item 13). Do not tighten immediately. Do not install the retaining plate on the right side immediately.
2. Fasten the cylinder bracket (item 1) on the 17/32" hole in the snowblower housing with a 1/2"NC x 1 1/4" bolt (item 10), a flatwasher (item 16) and a serrated flange nut (item 13).
3. Install the spacer (item 5) on the frame. Insert the bushing (item 6) in the hole on the bell crank (item 2). Slide the bell crank between the flatbars of the cylinder bracket (item 1) opposite the 13/16" hole on the housing.
4. **For SA74 & SA80:** Insert the upper three points attaching plate in the opening located behind the frame. Secure with a 3/4" lockwasher (item 15), a 3/4"NC x 5" bolt (item 9) and a 3/4" NC nut (item 12), as shown on figure below. Tighten securely. Install the push arm (item 3) by sliding it under the flatbar welded to the chute (as shown on figure), and insert a flatwasher 9/16" (item 16) and a 1/2" x 3/4" x 3/8"NC shoulder screw (item 7) under the part, by tipping the chute over. Tighten with a 7/16" flatwasher (item 17) and a 3/8"NC stover nut (item 14) leaving some movement to the push arm.

5. **For B84 & B94:** Fasten everything with a 3/4"NC x 5" bolt (item 9) (For models prior to 2002, use a 3/4" NC x 4 1/2" bolt), lockwasher (item 15) and nut (item 12), as shown on figure below. Tighten securely. Install the push arm (item 3) by sliding it over the flatbar welded to the chute (opposite as what shown on figure), and insert a flatwasher 9/16" (item 16) and a 1/2" x 3/4" x 3/8"NC shoulder screw (item 7) under the part, by tipping the chute over. Tighten with a 7/16" flatwasher (item 17) and a 3/8"NC stover nut (item 14) leaving some movement to the push arm.
6. Slide the other push arm end over the bell crank (item 2), inserting a 9/16" flatwasher in between. Insert a 1/2" x 1" x 3/8"NC shoulder screw (item 8) under the part. Tighten with a 7/16" flatwasher (item 17) and a 3/8"NC stover nut (item 14) leaving some movement to the mechanism.
7. Install the retaining plate on the right side.

Note: Grease the base of the chute regularly to avoid premature wear.

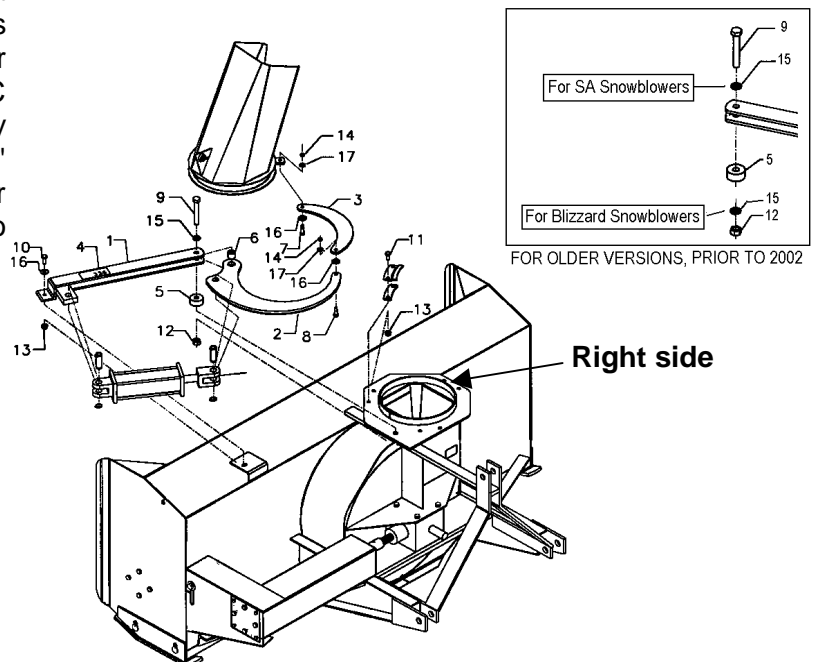



INSTRUCTION SHEET

8046 ROTATION WITH CYLINDER

HYDRAULIC ROTATION BY CYLINDER- KIT 8046

REF.	DESCRIPTION	QTY	PART #
1	Cylinder bracket	1	664475
2	Bell crank	1	664473
3	Push arm	1	664474
4	Decal # 336	1	664548
5	Spacer	1	664477
6	Bushing	1	664476
7	Shoulder screw 1/2" dia. x 1"lg, 3/8" NC	1	664578
8	Shoulder screw 1/2" dia. x 3/4"lg, 3/8" NC	1	664577
9	Bolt hex. 3/4" NC x 5"	1	O/L
	Bolt hex. 3/4" NC x 4 1/2" (For B84 & B94 old models, prior to 2002)	1	O/L
10	Bolt hex. 1/2" NC x 1 1/4"	3	O/L
11	Flatwasher 7/16"	2	O/L
12	Nut hex. 3/4" NC	1	O/L
13	Serrated flange nut 1/2" NC	3	O/L
14	Stover Nut 3/8" NC	2	O/L
15	Lockwasher 3/4"	1	O/L
16	Flatwasher 9/16"	3	O/L

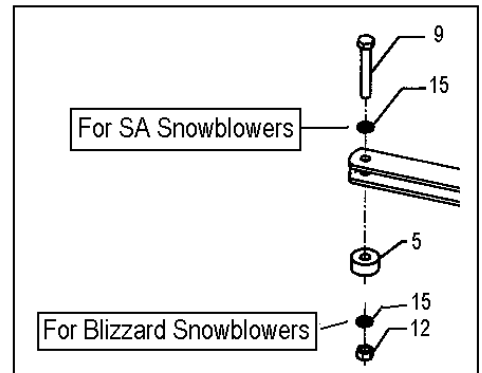
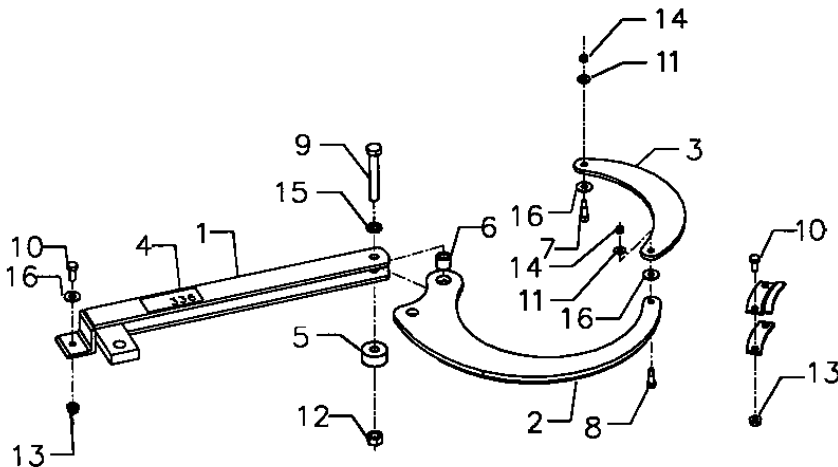

FOR OLDER VERSIONS, PRIOR TO 2002