



## INSTRUCTION SHEET

## 8046 ROTATION WITH CYLINDER

### Hydraulic Rotation with Cylinder - Kit 8046 (Figure below ↓)

1. Attach the chute with the retaining plates and spacers, and fasten with six 1/2"NC x 1 1/4"LG bolts, lockwashers and nuts (items 13-8-7). Do not tighten immediately.
2. Fasten the cylinder bracket (item 1) on the 17/32" holes in the snowblower housing with a 1/2"NC x 1 1/4" LG bolt, hex. nut, lockwasher and flatwasher (items 13-7-8-10).
3. Install the spacer (item 4) on the frame. Insert a bushing (item 5) in the hole of the bell crank (item 2). Slide the bell crank between the flat bars of the cylinder bracket opposite the 13/16"dia. hole.
4. **For SA74 & SA80:** Insert the upper three points attaching plate in the opening located behind the frame. Secure with a 3/4" lockwasher (item 15) and a 3/4"NC x 5" lg bolt (item 12), as shown on figure below. Tighten securely.
5. **For B84 & B94:** Fasten everything with a 3/4"NC x 4 1/2" lg bolt (item 12), lockwasher and nut (items 15-16), as shown on figure below. Tighten securely.
6. Install the push arm (item 3) by sliding it under the flat bar welded to the chute, and insert a flat washer 9/16" (item 10) and a 1/2" x 3/4" x 3/8"NC shoulder screw (item 11) under the part. Tighten with a 7/16" flat washer and a 3/8"NC stover nut (items 6-9) leaving some movement to the push arm.
7. Slide the other push arm end between the bell crank flat bars, and insert a 1/2" x 1" x 3/8"NC shoulder screw (item 14) under the part. Tighten with a 9/16" dia. hole flat washer, a 7/16" flat washer and a 3/8"NC stover nut (items 10-6-9) leaving some movement to the mechanism.

**Note:** Grease the base of the chute regularly to avoid premature wear.

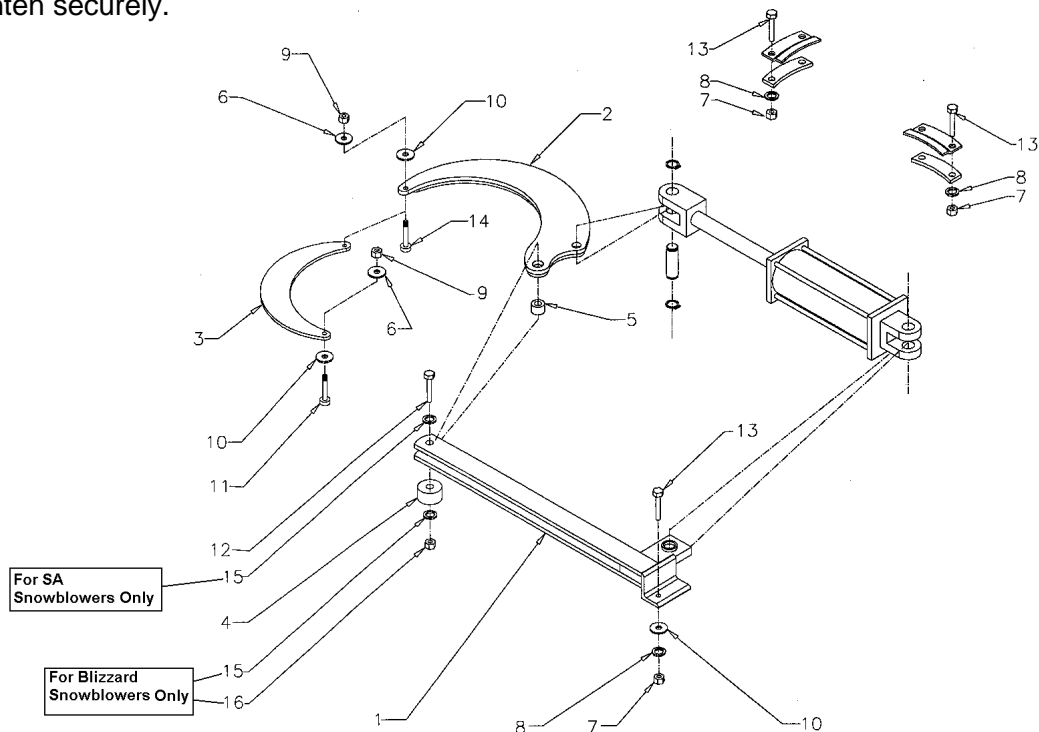



# INSTRUCTION SHEET

# 8046 ROTATION WITH CYLINDER

## HYDRAULIC ROTATION BY CYLINDER- KIT 8046

REF.	DESCRIPTION	QTY	PART #
1	Cylinder Bracket	1	664475
2	Bell Crank	1	664473
3	Push Arm	1	664474
4	Spacer	1	664477
5	Bushing	1	664476
6	Flatwasher 7/16"	2	O/L
7	Hex. Nut 1/2" NC	3	O/L
8	Lockwasher 1/2"	3	O/L
9	Stover Nut 3/8" NC	2	O/L
10	Flatwasher 9/16"	3	O/L
11	Shoulder Screw 1/2" dia. x 3/4"lg, 3/8" NC	1	664577
12	Bolt hex. 3/4" NC x 4 1/2" (For B84 & B94 snowblowers only)	1	O/L
	Bolt hex. 3/4" NC x 5" (For SA74 & SA80 snowblowers only)	1	O/L
13	Bolt hex. 1/2" NC x 1 1/4"	3	O/L
14	Shoulder Screw 1/2" dia. x 1"lg, 3/8" NC	1	664578
15	Lockwasher 3/4"	1	O/L
16	Nut hex. 3/4" NC (For B84 & B94 only)	1	O/L

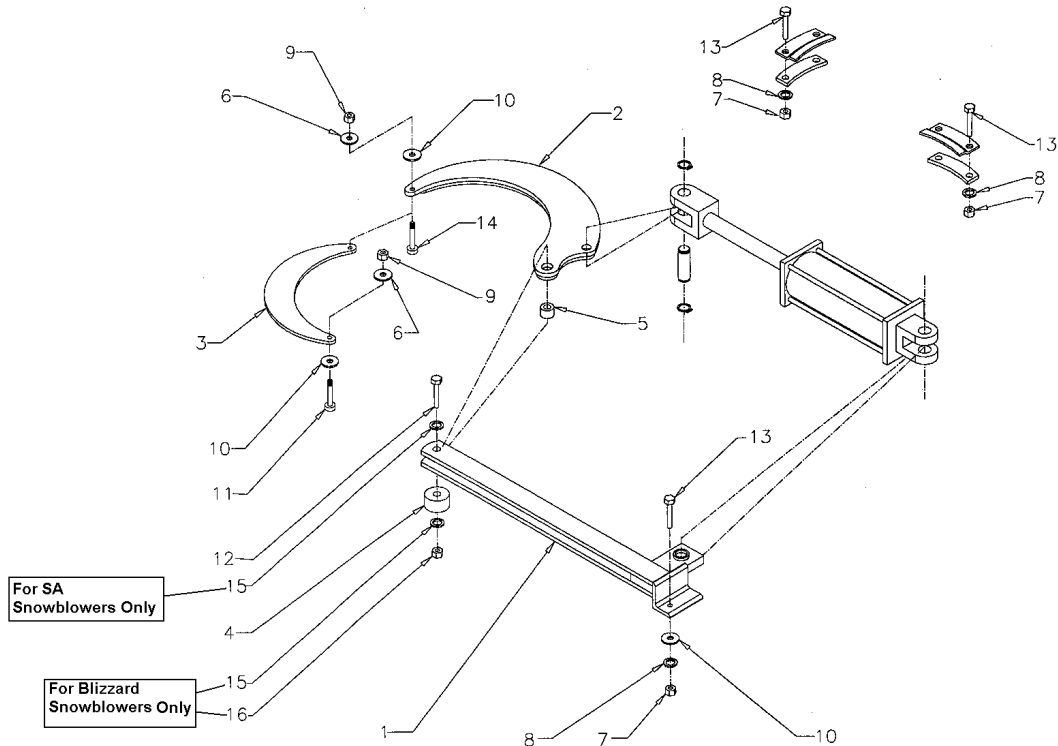



---

**INSTRUCTION SHEET**

**8046 ROTATION WITH CYLINDER**